

T SERIES

The SIGMA T-Series range of air conditioning units is specifically engineered to provide climate control for cabins in heavy-duty, off-road mining equipment.

Designed to endure the most demanding conditions, these units can withstand high levels of vibration, shock loads, and extreme ambient temperatures. Built to Mining Standards, they are crafted for ease of service and incorporate only the highest quality components.

MODEL	PAGE
TCF6BX2 (H0095174)	80
TCF7BX2	82
TCF8BX6 (H0235424)	84
TCW5	86 - 87
TCW5BX1	86
TCW5BX2	86
H0269191	88
TFC6BX2 (H0094278)	90
TFC8	92 - 93
TFC8BX5 (H0406943)	92
TFC8BX6 (H0407003)	92
TFF5	94 - 95
TFF5BX1	94
TFF5BX2	94
TFR7BX2	96



TCF6BX2

WALL MOUNT CONDENSER

H0095174

Wall Mount Condenser 6kW 24V

COOLING
6.0 kW
20,472 BTU

AIR FLOW
650 l/s
1,377 CFM

POWER SUPPLY
24 VDC



SPARE PARTS

PART NO.	DESCRIPTION	QTY
1	H0144118 CONDENSER FAN ASSEMBLY	2
2	H0148597 HIGH PRESSURE SWITCH ASSEMBLY	1
3	H0095176 CONDENSER COIL 650MM X 381MM X 66MM 4R	1
4	H0095336 LIQUID LINE ASSEMBLY - RECEIVER DRIER OUT	1
5	H0095339 LIQUID LINE ASSEMBLY - RECEIVER DRIER IN	1
6	AU531422 RECEIVER DRIER	1

SPECIFICATIONS

	METRIC	IMPERIAL
Cooling Capacity	6.0 kW	20,472 BTU
Fan Speeds	1	1
Air Flow	650 l/s	1,377 CFM
Power Supply	24 VDC	24 VDC
Current Draw	11A	11A
Refrigerant	R134a	R134a
Minimum Ambient Temp	-10°C	14°F
Maximum Ambient Temp	54°C	129.2°F
Weight (nominal)	35.0 Kg	77.0 lbs
Dimension (L X W X H)	800 mm X 294 mm X 647 mm	31.5 in X 11.6 in X 25.5 in

MAINTENANCE

ANNUAL / 4,800 HOURS

AU531422	RECEIVER DRIER
H0144118	CONDENSER FAN

3 YEARS / 14,400 HOURS

H0148597	HIGH PRESSURE SWITCH ASSEMBLY
----------	-------------------------------

COMPANION ITEMS

PART NO.	DESCRIPTION
TFC6BX2	Rooftop Evaporator (6kW)
FVV40	Pressuriser
H0497644	Hydraulic Driven Compressor 170 ext (Vertical)

Please contact SIGMA for more information including details on an overhaul scope and interval. Maintenance periods and scope are dependent on application and site conditions, and are to be used as a guide.

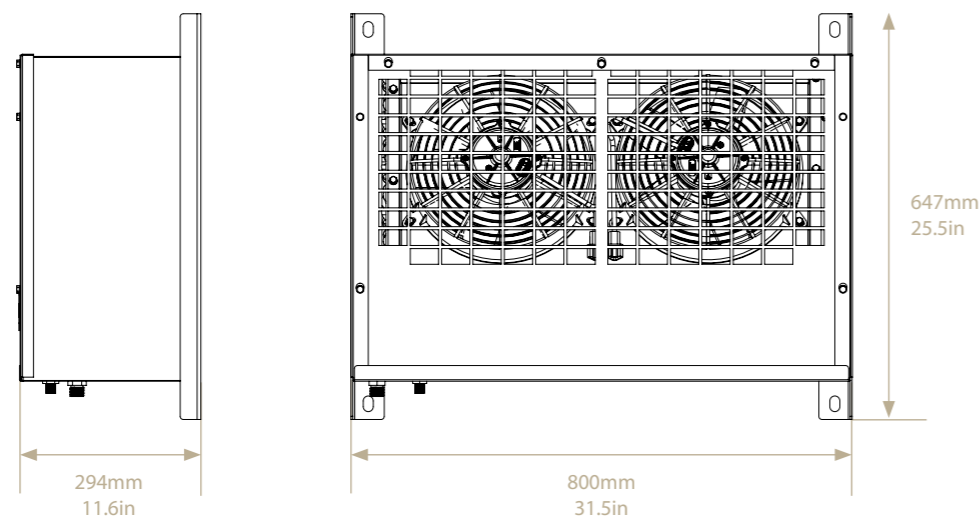
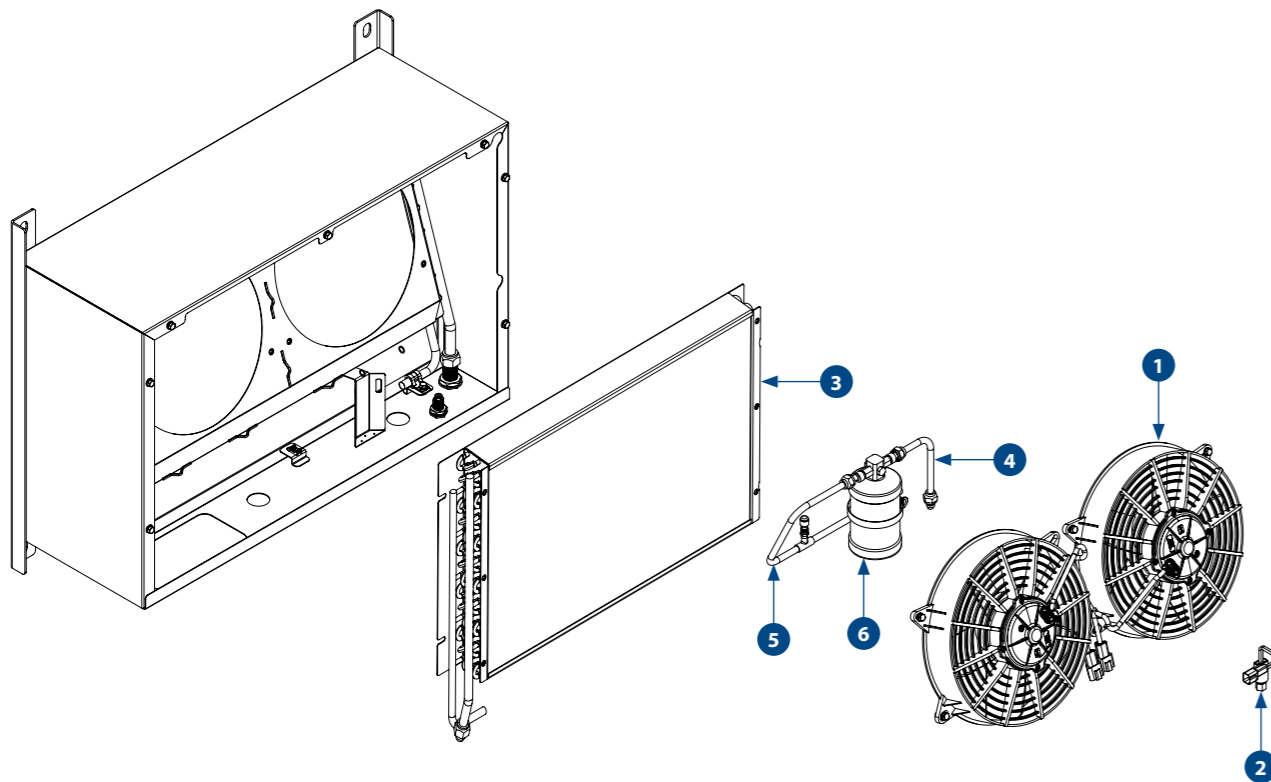

TCF7BX2

ROOFTOP CONDENSER

TCF7BX2

7kW 24V Condenser with O-Ring Fittings

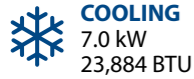

COOLING
7.0 kW
23,884 BTU



AIR FLOW
650 l/s
1,377 CFM



POWER SUPPLY
24 VDC

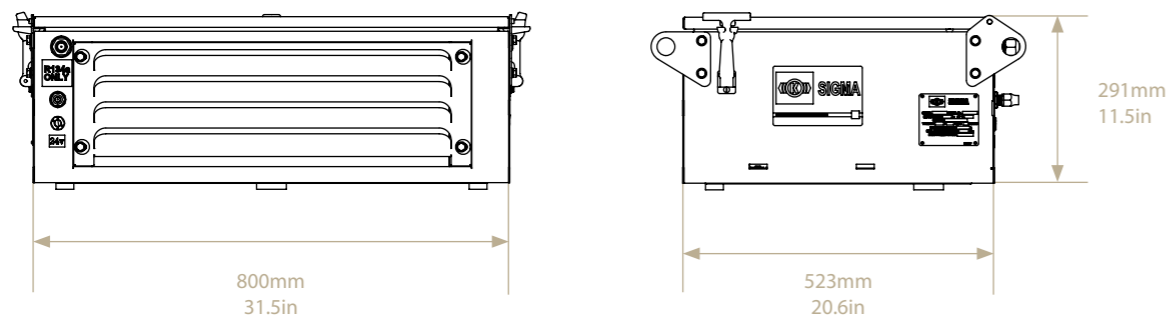
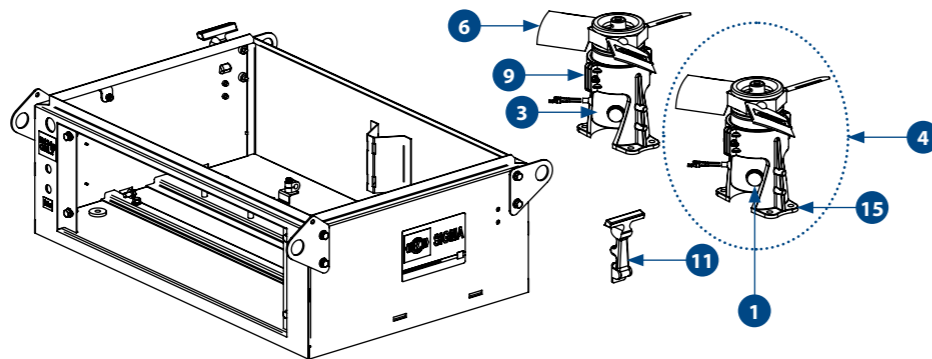
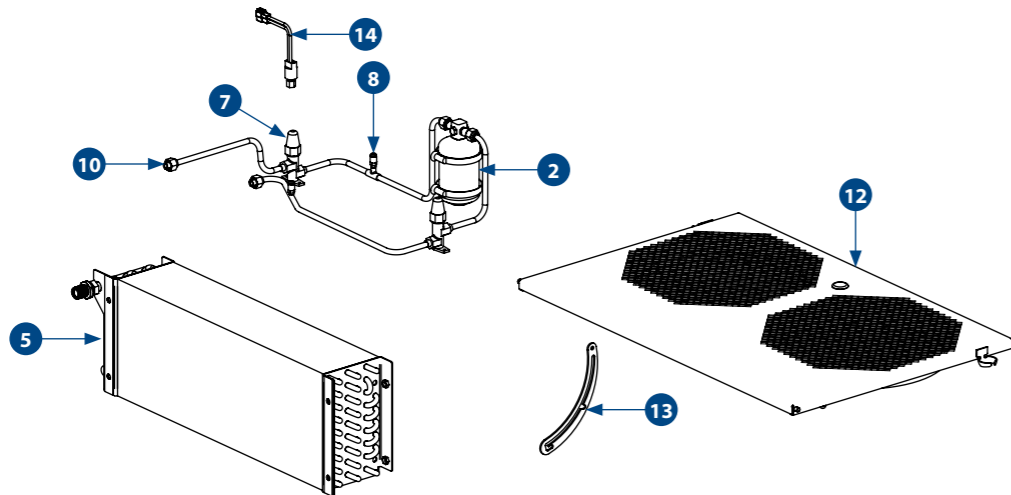

SPARE PARTS

PART NO.	DESCRIPTION	QTY
1	H0393309 MOTOR BRUSH 24VDC Previously AU320621	4
2	AU531411 RECEIVER DRIER 3/8" 24UNF 165MM HIGH	1
3	H0384821 24V DC SINGLE SHAFT BRUSHED MOTOR Previously UE026	2
4	AS5000170 CONDENSER FAN ASSEMBLY 24V	2
5	AU110029 CONDENSER COIL 6R (TCF7BX2)	1
6	AU420229 FAN AXIAL 300MM 3 BLADES LB	2
7	AU517254 PCAV 3/8" SOLDER	2
8	AU517505 VALVE ACCESS 1/4" 1/8" OD SOLDER	1
9	UC028 CONDENSER MOTOR MOUNT	4
10	AU512C065 BULKHEAD FITTING O-RING 3/8" (TCF7BX2)	1
11	AU851590 TOGGLE CLAMP RUBBER (TCF7BX2)	2
12	AS5000125 CONDENSER LID W/ASSEMBLY	1
13	S5000149 LID PROP	1
14	H0472020 HIGH PRESSURE SWITCH WITH PLUG	1
	AS515203 LIQUID LINE VALVE TO DRIER	1
	AS515204 LIQUID LINE DRIER TO RECEIVER	1
	AS515205 LIQUID LINE RECEIVER TO VALVE	1
	AU935432 FLAT NEOPRENE EXTRUSION	2

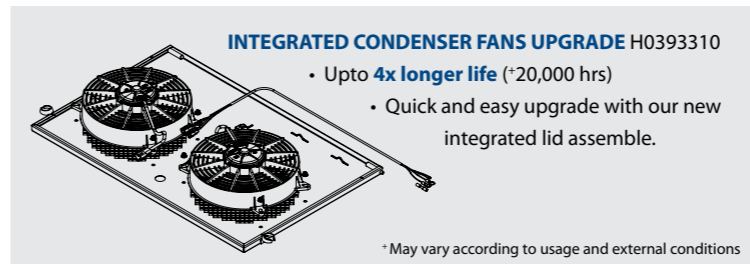

SPECIFICATIONS

	METRIC	IMPERIAL
Cooling Capacity	7.0 kW	23,884 BTU
Fan Speeds	1	1
Air Flow	650 l/s	1,377 CFM
Power Supply	24 VDC	24 VDC
Current Draw	20 A	20 A
Refrigerant	R134a	R134a
Maximum Ambient Temperature	54°C	129°F
Weight (nominal)	35.0 Kg	77.0 lbs
Dimension (L X W X H)	800 mm X 523 mm X 291mm	31.5 in X 20.6 in X 11.5 in

MAINTENANCE

6 MONTHS / 2,400 HOURS

H0393309 MOTOR BRUSH 24VDC

ANNUAL / 4,800 HOURS

AU531411 RECEIVER DRIER 3/8" 24UNF165MM HIGH

H0384821 24V DC SINGLE SHAFT BRUSHED MOTOR

3 YEARS / 14,400 HOURS

H0472020 HIGH PRESSURE SWITCH WITH PLUG

COMPANION ITEMS

PART NO.	DESCRIPTION
H0393310	Integrated Condenser Fans Assembly
TFR7BX2	Rooftop Evaporator (7kW)
FV40	Pressuriser
H0404765	Hydraulic Compressor 170 (vertical)
H0404764	Hydraulic Compressor 170 (Horizontal)
AU270315E	Compressor UP170 2A 24V HMO 132 ESTE
AU270317E	Compressor UP170 1B 24V HMO 135 ESTE

Please contact SIGMA for more information including details on an overhaul scope and interval.
Maintenance periods and scope are dependent on application and site conditions, and are to be used as a guide.

TCF8BX6

FLOOR MOUNTED CONDENSER

H0235424

8kW 24V Removable Lid Condenser with Brushless fan

 **COOLING**
8.0 kW
27,296 BTU

 **AIR FLOW**
980 l/s
2,077 CFM

 **POWER SUPPLY**
24 VDC

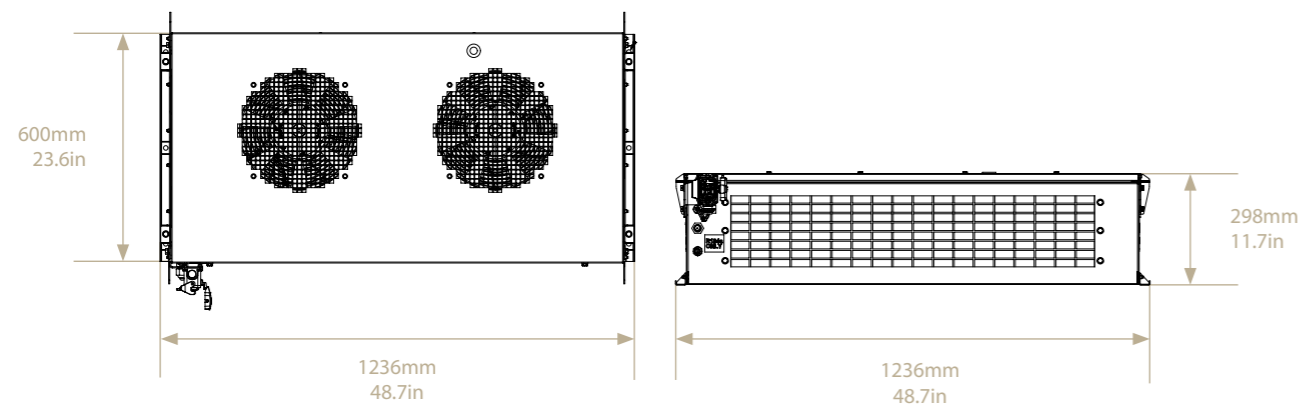
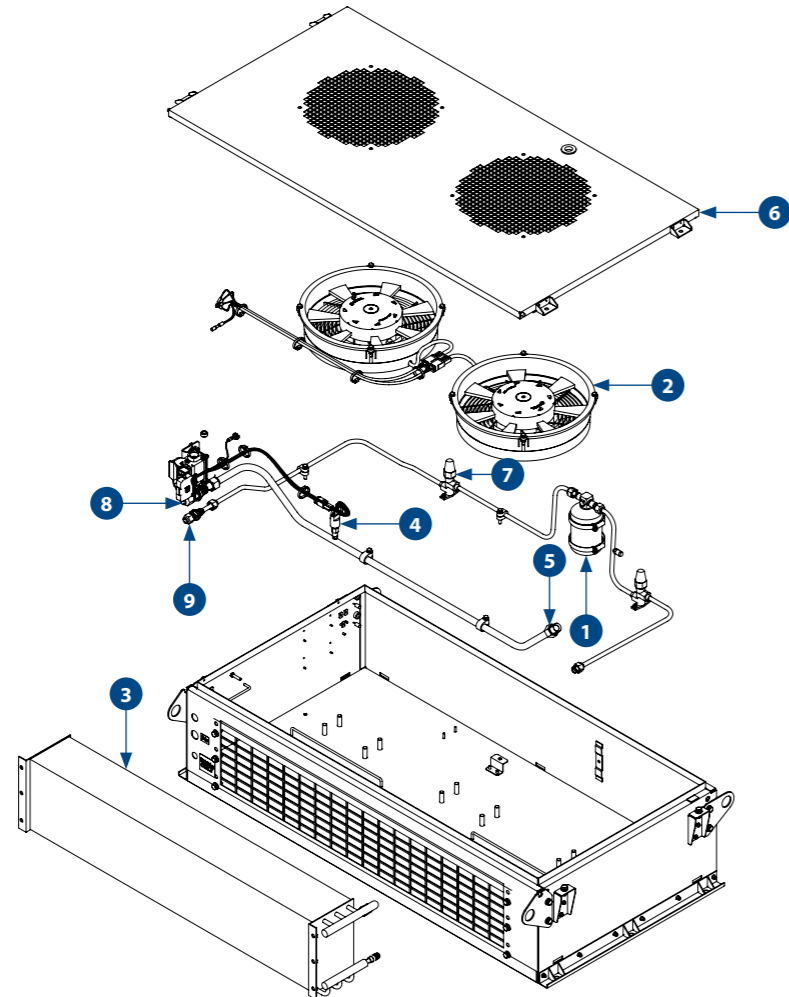

SPARE PARTS

PART NO.	DESCRIPTION	QTY
1	AU531411 RECEIVER DRIER 3/8" 24UNF 165MM HIGH	1
2	H0192021 AXIAL BRUSHLESS FAN 24VDC DIA 305MM	2
3	AU110009 CONDENSER COIL 946X203X132MM 6RW	1
4	H0148597 HIGH PRESSURE SWITCH	1
5	H0234526 BULKHEAD HOUSING, SIDE ENTRY	1
6	H0192013 CONDENSER COVER ASSEMBLY	1
7	AU517254 PCAV 3/8" SOLDER	2
8	UR009 BULKHEAD FITTING 3/8" MF,	1
9	UR011 BULKHEAD FITTING 5/8" MF #10	1

SPECIFICATIONS

	METRIC	IMPERIAL
Cooling Capacity	8.0 kW	27,296 BTU
Fan Speeds	1	1
Air Flow	980 l/s	2,077 CFM
Power Supply	24 VDC	24 VDC
Current Draw	27A	27A
Refrigerant	R134a	R134a
Maximum Ambient Temperature	54°C	129°F
Weight (nominal)	50.0 Kg	110.0 lbs
Technical Manual Reference	1236mm X 600mm X 294mm	48.7in X 23.6in X 11.6in
Dimension (L X W X H)	1236 mm X 600 mm X 298 mm	48.7 in X 23.6 in X 11.7 in

MAINTENANCE

ANNUAL / 4,800 HOURS

AU531411 RECEIVER DRIER 3/8" 24UNF165MM HIGH

3 YEARS / 14,400 HOURS

H0148597 HIGH PRESSURE SWITCH 1/4" FF 2415kPa

H0193262 AXIAL BRUSHLESS FAN 24VDC DIA 305MM

COMPANION ITEMS

PART NO.	DESCRIPTION
H0406943	8kW Evaporator Unit 24VDC (TFC8BX5)
H0407003	8kW Evaporator Unit 24VDC C/W 415 Heating (TFC8BX6)
FVV40	Pressuriser
H0404767	Hydraulic Compressor 200 VERTICAL
H0404766	Hydraulic Compressor 200 HORIZONTAL
AU260203	Compressor 3Ph 60Hz
H0415158	Mating Plug Kit

Please contact SIGMA for more information including details on an overhaul scope and interval. Maintenance periods and scope are dependent on application and site conditions, and are to be used as a guide.

TCW5

WALL MOUNTED CONDENSER

TCW5BX1

5kW 24V Condenser Captive 'O'Ring

TCW5BX2

5kW 24V Condenser Standard 'O'Ring

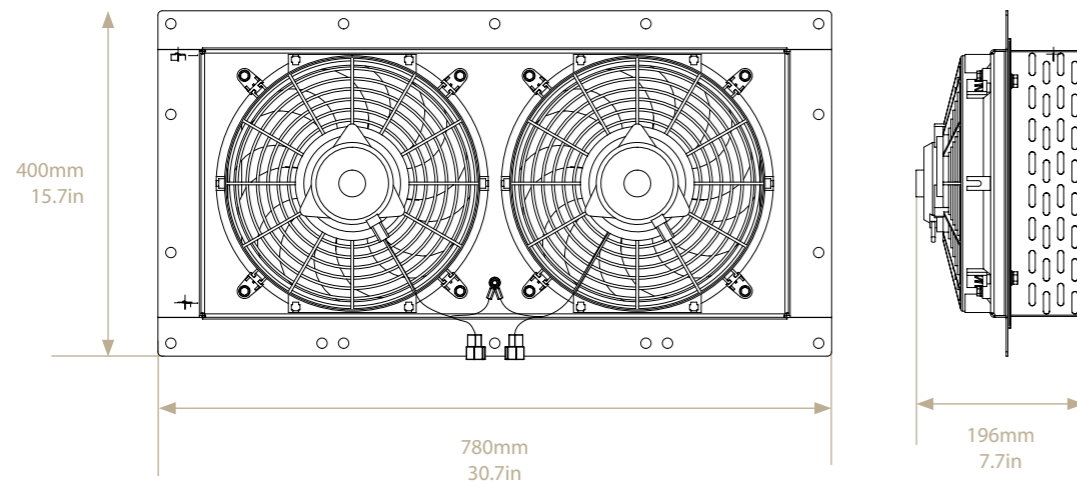
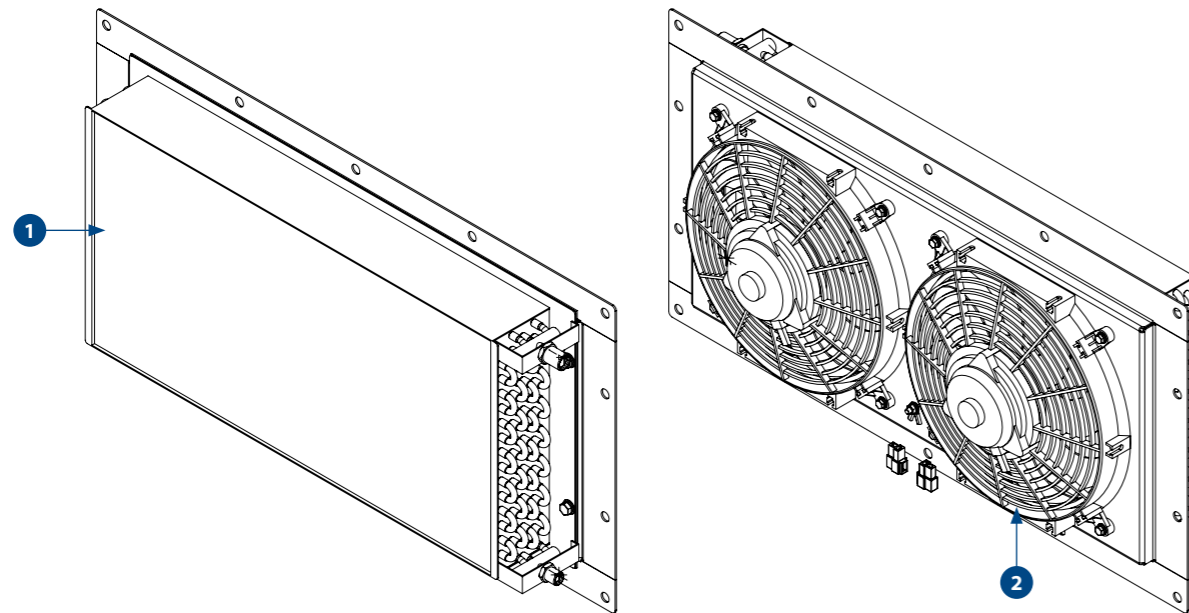
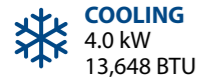

SPARE PARTS

PART NO.	DESCRIPTION	QTY
1 H0039196	CONDENSER COIL 600MM X 305MM X 66MM (BX1)	1
H0095147	CONDENSER COIL 600MM X 305MM X 66MM (BX2)	1
2 H0051777	FAN AXIAL ASSEMBLY 280MM 24VDC	2

SPECIFICATIONS

	METRIC	IMPERIAL
Cooling Capacity	4.0 kW	13,648 BTU
Fan Speeds	1	1
Air Flow	500 l/s	1,059 CFM
Power Supply	24 VDC	24 VDC
Current Draw	8A	8A
Refrigerant	R134a	R134a
Maximum Ambient Temperature	54°C	129°F
Weight (nominal)	19.0 Kg	41.9 lbs
Dimension (L X W X H)	780mm X 400mm X 196mm	30.7in X 15.7in X 7.7in

MAINTENANCE

ANNUAL / 4,800 HOURS

H0051777	FAN AXIAL ASSEMBLY 280MM 24VDC
----------	--------------------------------

COMPANION ITEMS

PART NO.	DESCRIPTION
TFF5BX1	5kW Evaporator Floor Mounted 12V
TFF5BX2	5kW Evaporator Floor Mounted 24V
FV40	Pressuriser
H0404763	Hydraulic Driven Compressor 150 (Vertical)
H0428289	Electric Compressor 24 V
AU270312	Engine Driven Compressor
AU270311	Engine Driven Compressor
H0081855	Receiver Drier
AU531422	Receiver Drier





Please contact SIGMA for more information including details on an overhaul scope and interval. Maintenance periods and scope are dependent on application and site conditions, and are to be used as a guide.

HPR6BX1

ROOFTOP HVAC UNIT

H0269191

6kW 24V HVAC Package with 11kW Heating

	COOLING 6.0 kW 20,472 BTU		HEATING (OPTION) 11.0 kW 37,533 BTU
	POWER SUPPLY 24 VDC		AIR FLOW 200 l/s 423 CFM

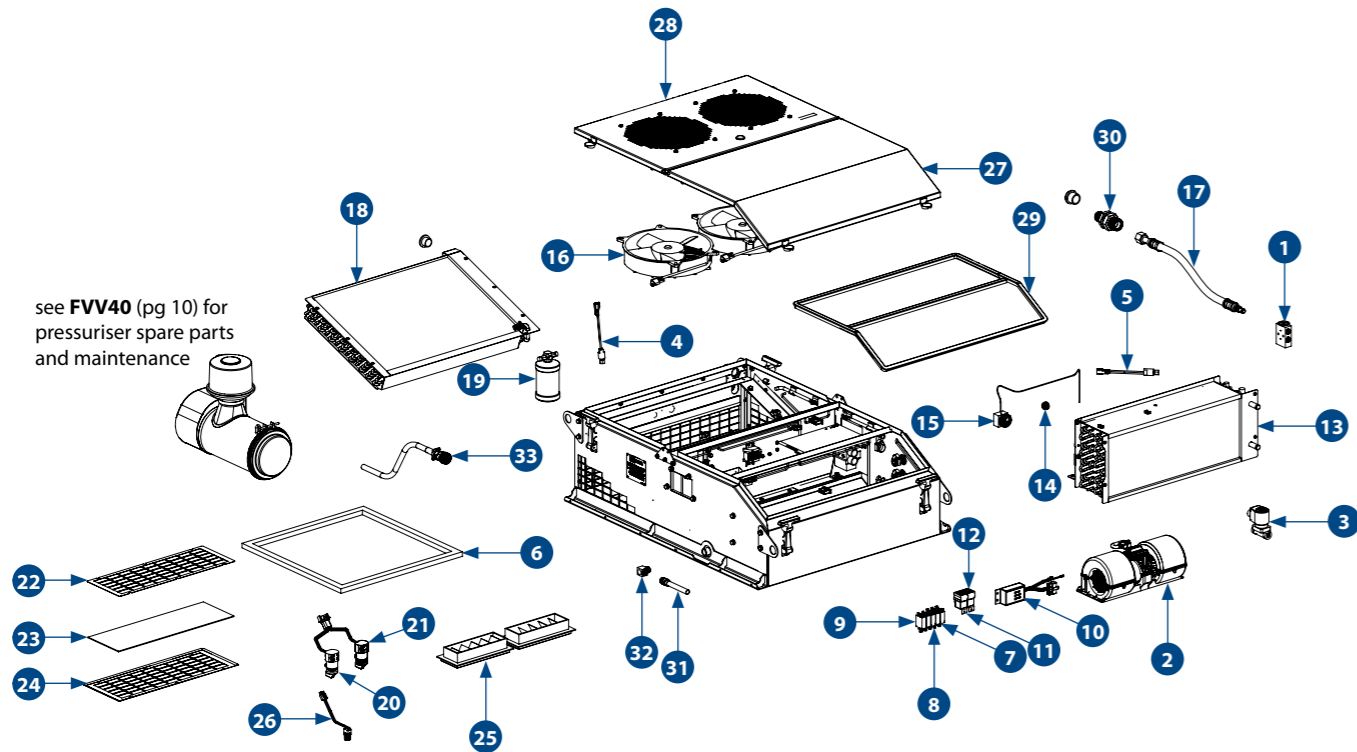

see **FVV40** (pg 10) for pressuriser spare parts and maintenance

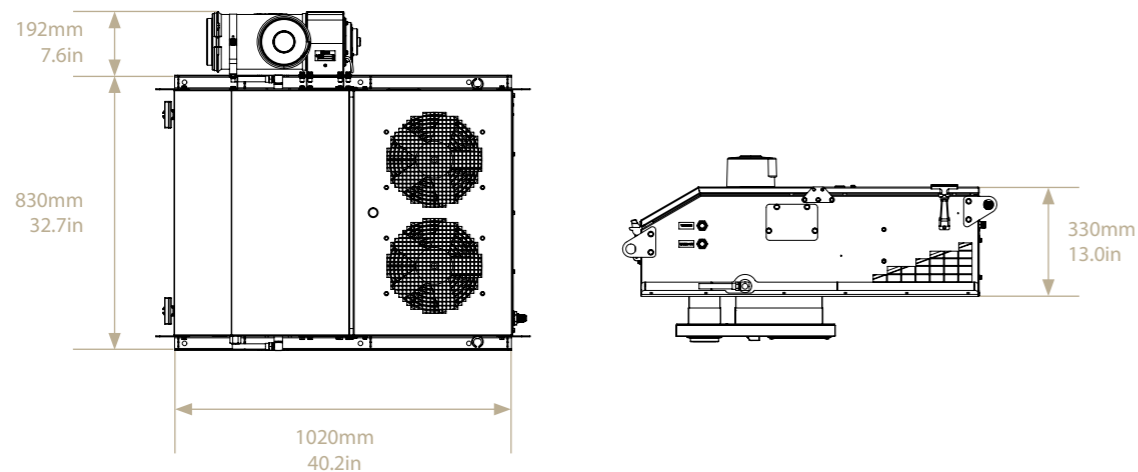

SPARE PARTS

PART NO.	DESCRIPTION	QTY
1	AU521946 TX VALVE BLOCK 2T	1
2	H0088451 BLOWER ASSY - 24VDC 3 SPEED	1
3	H0112397 SOL VLV 24VDC 1/2" BSP WATER	1
4	H0148597 HIGH PRESSURE SWITCH	1
5	H0152017 LOW PRESSURE SWITCH	1
6	H0247253 ROOF SEAL	1
7	AU641C107 CIRCUIT BREAKER 10A	2
8	AU641C110 CIRCUIT BREAKER 15A	1
9	AU641065 CIRCUIT BREAKER 25A	2
10	H0262987 THERMOSTAT INC SENSOR 12-24VDC	1
11	AU661483 RELAY 20A 24VDC	2
12	ERR023 RELAY BASE - PANEL MOUNT	2
13	H0258193 COIL EVAPORATOR HEAT	1
14	UC022 KNOB SNOWFLAKE	1
15	UE016 THERMOSTAT DE-ICE	1
16	H0144118 CONDENSER FAN 24VDC	2
17	H0280095 FLEXIBLE HOSE O RING STRAIGHT #12 & #10	1
18	H0258471 CONDENSER COIL	1
19	AU531422 RECEIVER DRIER WITH SIGHT GLASS 3/8" MIOR	1
20	AU663562 ROTARY SWITCH MODE	1
21	H0126519 ROTARY SWITCH FAN	1
22	H0251907 FILTER COVER, INSIDE	1
23	H0251908 FILTER CLOTH	1
24	H0252200 FILTER COVER, RETURN AIR	1
25	UC901 DIFFUSER	2
26	AU681926 POTENTIOMETER	1
27	H0258194 EVAPORATOR COVER, FINAL ASSEMBLY	1
28	H0258494 CONDENSER COVER, FINAL ASSEMBLY	1
29	AU862211 LID RUBBER SEAL	3.5
30	H0498827 BULKHEAD FITTING 5/8" X 3/4" MIO	1
31	H0498831 DRAIN PIPE, 136L x 1/2" MBSPT x 16OD	1
32	H0498832 FITTING, ELB 1/2 MBSPP X 1/2 FBSPP	1
33	H0498828 WIRING HARNESS,CAROL S00W 3C AWG10	1

SPECIFICATIONS

	METRIC	IMPERIAL
Cooling Capacity	6.0 kW	20,472 BTU
Heating Capacity	11.0 kW	37,533 BTU
Fan Speeds	3	3
Air Flow	200 l/s	423 CFM
Power Supply	24 VDC	24 VDC
Current Draw	25 A	25 A
Refrigerant	R134a	R134a
Minimum Ambient Temperature	- 10°C	14°F
Maximum Ambient Temperature	54°C	129°F
Weight (nominal)	90.0 Kg	198.4.0 lbs
Technical Manual Reference	HD0148021	HD0148021
Dimension (L X W X H)	1020 mm X 830 mm X 330 mm	40.2 in X 32.7 in X 13.0 in

MAINTENANCE

MONTHLY / 400 HOURS

H0251908	Filter Cloth
----------	--------------

ANNUAL / 4,800 HOURS

AU531422	RECEIVER DRIER
H0088451	BLOWER ASSY - 24VDC 3 SPEED
H0144118	CONDENSER FAN 24VDC

3 YEARS / 14,400 HOURS

AU521946	TX VALVE BLOCK 2T
H0148597	HIGH PRESSURE SWITCH
H0152017	LOW PRESSURE SWITCH
H0262987	THERMOSTAT INC SENSOR 12-24VDC
AU681926	POTENTIOMETER
AU862211	LID RUBBER SEAL
H0280095	FLEXIBLE HOSE O RING STRAIGHT #12 & #10
UE016	THERMOSTAT DE-ICE
AU661483	RELAY 20A 24VDC

COMPANION ITEMS

PART NO.	DESCRIPTION
H0404765	Hydraulic Driven Compressor 170 (V)
H0404764	Hydraulic Driven Compressor 170 (H)
AU270306	Engine Driven Compressor
AU270307	Engine Driven Compressor

TFC6

CEILING EVAPORATOR

H0094278 (TFC6BX2)

6kW 24V Evaporator with Heating (7kW)

H0552560 (TFC6BX3)

6kW 24V Evaporator with Electric Heating



COOLING
6.0 kW
20,472 BTU

HEATING (OPTION)
7.0 kW
23,884 BTU

POWER SUPPLY
24 VDC

AIR FLOW
200 l/s
424 CFM

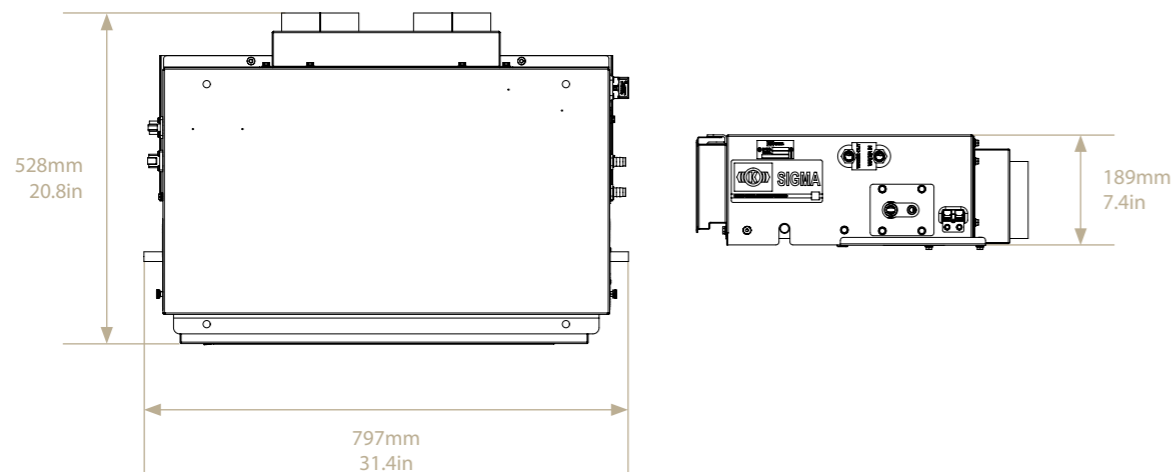
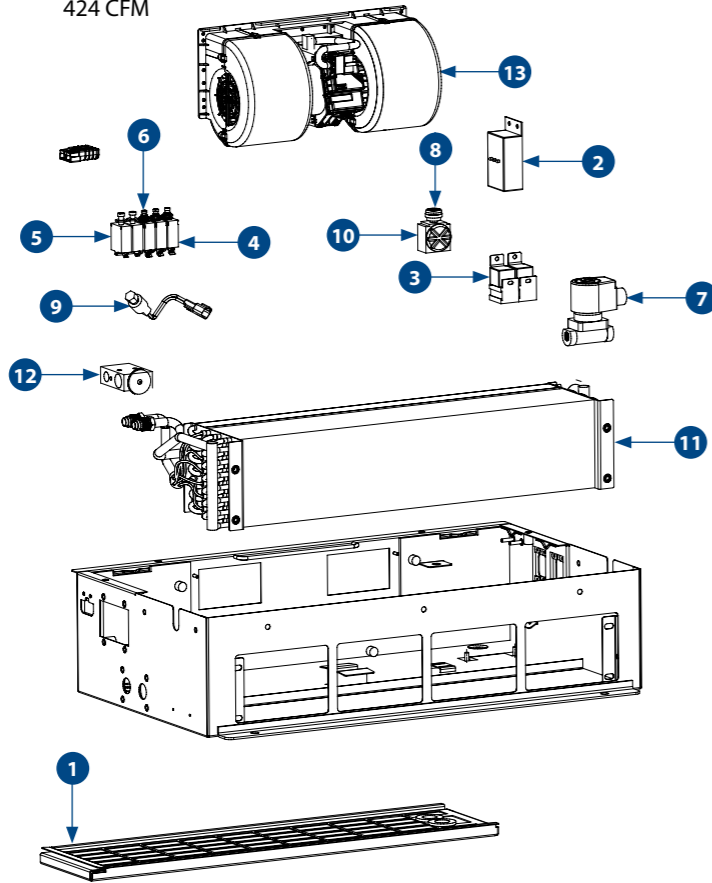

SPARE PARTS

PART NO.	DESCRIPTION	QTY
1 AS502003 H0467593	RETURN AIR FILTER ASSY RETURN AIR FILTER MEDIA FOR AS502003	1 1
2 H0262987	THERMOSTAT Previously AU681925	1
3 AU661483 AU661483	RELAY 20A 24VDC 5 PIN (TFC6BX2) RELAY 20A 24VDC 5 PIN (TFC6BX3)	2 3
AU641C107	CIRCUIT BREAKER 10A PUSH PULL (TFC6BX2)	2
4 AU641C107 AU641C111	CIRCUIT BREAKER 10A PUSH PULL (TFC6BX3) CIRCUIT BREAKER 5A PUSH PULL (TFC6BX3)	3 1
5 AU641C110	CIRCUIT BREAKER 15A PUSH PULL	1
6 AU641065	CIRCUIT BREAKER 25A PUSH PULL	2
7 H0112397	SOLENOID VALVE 24VDC 1/2" BSP WATER	1
8 UC022	KNOB SNOWFLAKE 6.35MM	1
9 H0152017	LP SWITCH ASSEMBLY	1
10 UE016	THERMOSTAT DEICE STUD	1
11 H0094351 H0552563	EVAPORATOR + HEATER COIL (TFC6BX2) EVAPORATOR + HEATER COIL (TFC6BX3)	1 1
12 AU521946	TX VALVE BLOCK 2T 3/8" IN 1/2" OUT R134A	1
13 H0088451	BLOWER ASSEMBLY - 24VDC 3 SPEED	1

SPECIFICATIONS

	METRIC	IMPERIAL
Cooling Capacity	6.0 kW	20,472 BTU
Heating Capacity	7.0 kW	23,884 BTU
Fan Speeds	3	3
Air Flow	200 l/s	424 CFM
Fresh Air (Optional)	40 l/s	85 CFM
Power Supply	24 VDC	24 VDC
Current Draw	13 A	13 A
Refrigerant	R134a	R134a
Minimum Ambient Temperature	-10°C	14°F
Maximum Ambient Temperature	54°C	129°F
Weight (nominal)	35.0 Kg	77.0 lbs
Technical Manual Reference	HD0041895	HD0041895
Dimension (L X W X H)	797 mm X 528 mm X 189 mm	31.4 in X 20.8 in X 7.4 in

MAINTENANCE

MONTHLY / 400 HOURS

AS502003	RETURN AIR FILTER
H0467593	RETURN AIR FILTER MEDIA

ANNUAL / 4,800 HOURS

H0088451	BLOWER ASSEMBLY - 24VDC 3 SPEED
----------	---------------------------------

3 YEARS / 14,400 HOURS

H0262987	THERMOSTAT
AU661483	RELAY 20A 24VDC 5 PIN
H0112397	SOLENOID VALVE 24VDC 1/2" BSP WATER
UE016	THERMOSTAT DEICE STUD
AU521946	TX VALVE BLOCK 2T 3/8" IN 1/2" OUT R134A

COMPANION ITEMS

PART NO.	DESCRIPTION
H0095174	Wall mount Condenser 6kW 24V (TCF6BX2)
FVV40	Pressuriser
H0123925	Evaporator to Switch Loom
H0124104	Switch Panel Remote Assembly

Please contact SIGMA for more information including details on an overhaul scope and interval. Maintenance periods and scope are dependent on application and site conditions, and are to be used as a guide.

TFC8

CEILING EVAPORATOR

H0406943 (TFC8BX5)

8kW 24V Evaporator

H0407003 (TFC8BX6)

8kW 24V Evaporator with Electric Heating

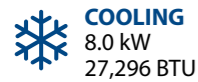

COOLING
8.0 kW
27,296 BTU



HEATING (OPTION)
upto 11.0 kW
upto 37,533 BTU



POWER SUPPLY
24 VDC



AIR FLOW
230 l/s
487 CFM

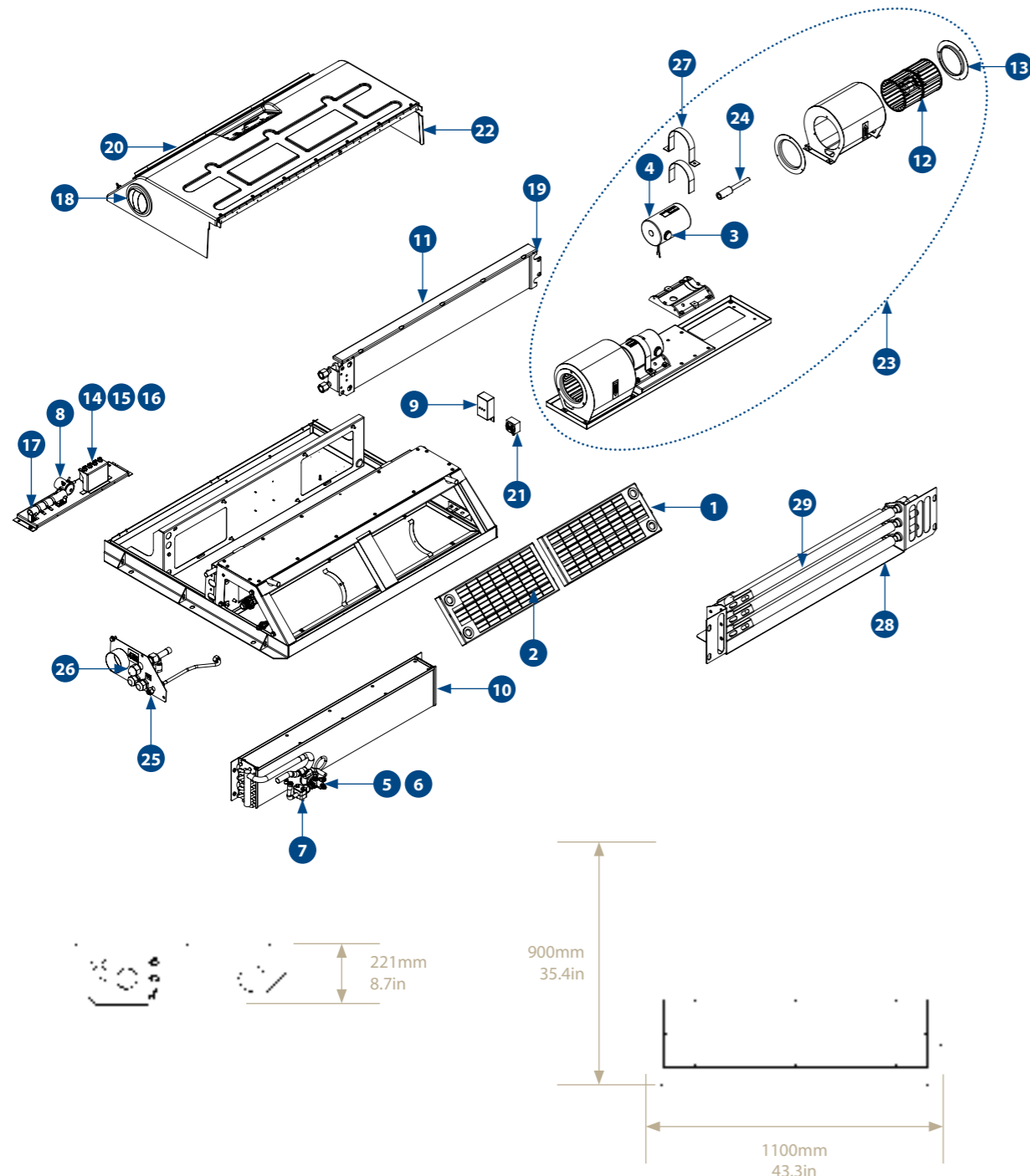

SPARE PARTS

PART NO.	DESCRIPTION	QTY
1	AS271535 RETURN AIR FILTER	2
2	S2715039 FILTER MEDIA FOR AS271535 ONLY	2
3	H0393309 MOTOR BRUSH 24VDC for H0384821 Previously AU320622 for H0039230	4
4	H0384821 24V DC SINGLE SHAFT BRUSHED MOTOR Previously H0039230	2
5	H0407004 THERMAL EXPANSION VALVE Previously AU521509	1
6	H0407005 THERMAL EXPANSION ORIFICE NOZZLE Previously AU521508	1
7	AU523365 LOW PRESSURE SWITCH 1/4" FF 205kPa	1
8	UE072 RELAY 24VDC 70A AUTOMOTIVE	1
9	H0262987 THERMOSTAT	1
10	AU120394 EVAPORATOR COIL 864MM X 166MM X 95MM 4RW TFC8	1
11	AU130009 HEATER COIL 864MM X 152MM X 32MM 2RW TFC8	1
12	AU410105 BLOWER 120D X 178W X 3/8 CW DUAL INLET	2
13	AU410902 INLET RING 105MM	4
14	AU641065 CIRCUIT BREAKER 25A PUSH PULL	1
15	AU641067 CIRCUIT BREAKER 35A PUSH PULL	1
16	AU641C111 CIRCUIT BREAKER 5A PUSH PULL	2
17	AU692107 RESISTOR 2 OHM 100W 3 CLIPS ADJUSTABLE	1
18	AU821300 DIFFUSER ROUND 120MM POLYAMIDE	2
19	UC027 EVAPORATOR MOTOR MOUNT	2
20	UC901 DIFFUSER 246 X 104MM	3
21	UE016 THERMOSTAT DEICE STUD	1
22	AS271543 TFC8 COVER ASSEMBLY	1
23	H0408797 SUPPLY AIR FAN ASSEMBLY Previously AS271531	1
24	AU872135 SHAFT EXTENSION 1/2" FEMALE X 1/2" MALE	2
25	UR009 BULKHEAD FITTING 3/8" MF,	1
26	UR010 BULKHEAD FITTING 3/4" MF,	1
27	S5006029 MOTOR MOUNT CLAMP 97MM	2
28	AS271576 HEATER ASSEMBLY (BX6)	1
29	AU691191 HEATER U SHAPE 2.0kW 240V 675MM SS FIN (BX6)	1
	AU663563 ROTARY SWITCH A B C D FAN	1
	AU663569 ROTARY SWITCH MODE	1
	UE057 VALVE SOLENOID 1/4" BSP 24VDC WATER	1
	UC504 DRAIN NOZZLE 13MM	4
	AU681065 THERMOSTAT T3 80°C SPST AUTO (BX6)	1
	AU651346 CONTACTOR 12A 24VDC 3 POLE 1NO 1NC (BX6)	1
	AU641451 CIRCUIT BREAKER 6.3-10A 3 POLE (BX6) Previously AU641601	2
	AU641612 CIRCUIT BREAKER 16A 3POLE (BX6)	1
	AU662410 SWITCH KEYED 20A (BX6)	1
	UC031 FASTENER ASSEMBLY 1/4 TURN - STUD & RECEIPT	3
	UE699 CIRCUIT BREAKER 60A STUD TYP MANUAL (BX5)	1

SPECIFICATIONS

	METRIC	IMPERIAL
Cooling Capacity	8.0 kW	27,296 BTU
Heating Capacity	11 kW	37,533 BTU
Electric Heating Capacity	6.0 kW	20,472 BTU
Fan Speeds	3	3
Air Flow	230 l/s	487 CFM
Power Supply	24 VDC	24 VDC
Current Draw	25 A	25 A
Refrigerant	R134a	R134a
Minimum Ambient Temperature	-10°C	14°F
Maximum Ambient Temperature	54°C	129°F
Weight (nominal)	90 kgs	198.4 lbs
Technical Manual	HD0148021	HD0148021
Dimension (L X W X H)	1100 mm X 900 mm X 221 mm	43.3 in X 35.4 in X 8.7 in

MAINTENANCE

MONTHLY / 400 HOURS

AS271535	RETURN AIR FILTER
S2715039	FILTER MEDIA FOR AS271535 ONLY

6 MONTHS / 2,400 HOURS

H0393309	MOTOR BRUSH 24VDC EACH
----------	------------------------

ANNUAL / 4,800 HOURS

H0384821	BRUSHED MOTOR, FOR 24V DC
----------	---------------------------

3 YEARS / 14,400 HOURS

H0407004	THERMAL EXPANSION VALVE
H0407005	THERMAL EXPANSION ORIFICE NOZZLE
AU523365	LOW PRESSURE SWITCH
UE016	THERMOSTAT DE-ICE
AS271543	TFC8 Cover assembly
UE072	RELAY 24VDC 70A AUTOMOTIVE
UE057	VALVE SOLENOID 1/4" BSP 24VDC WATER
H0262987	POTENTIOMETER

COMPANION ITEMS

PART NO.	DESCRIPTION
AS2715355	Return Air Filter - Disposable Option
H0404766	Hydraulic Driven Compressor 200 Horizontal
AU1102401	Radiator Condenser
AU270314	Engine Driven Compressor
AU2701001	Engine Driven Compressor
AU531411	Receiver Drier
AU531422	Receiver Drier
H0235424	Electric Condenser
FVV40	Pressuriser
H0404767	Hydraulic Driven Compressor 200 (Vertical)

TFF5

FLOOR MOUNTED EVAPORATOR

TFF5BX1

4kW 24V Evaporator with Heating (SV Front Mounted)

TFF5BX2

4kW 24V Evaporator with Heating (SV Rear Mounted)

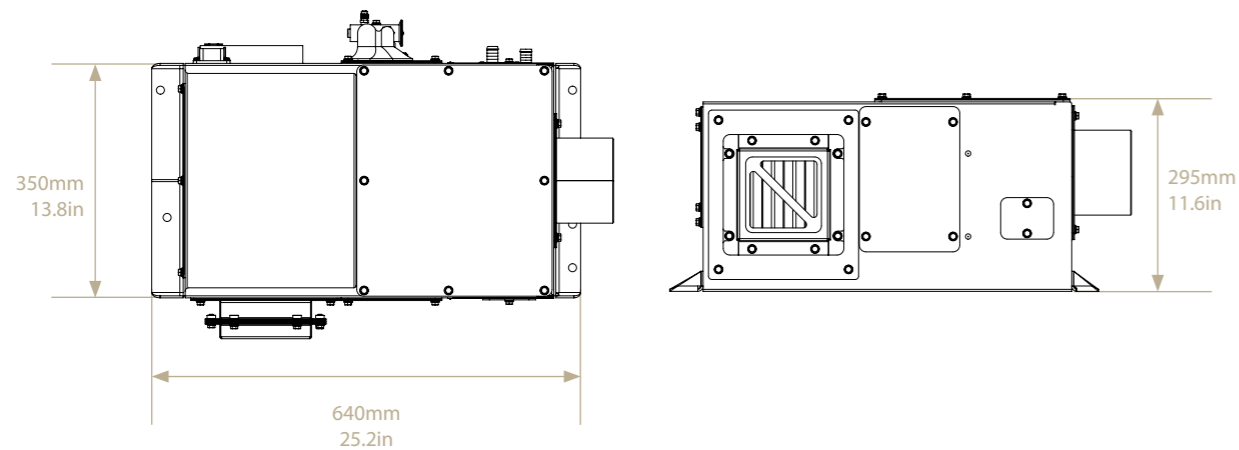
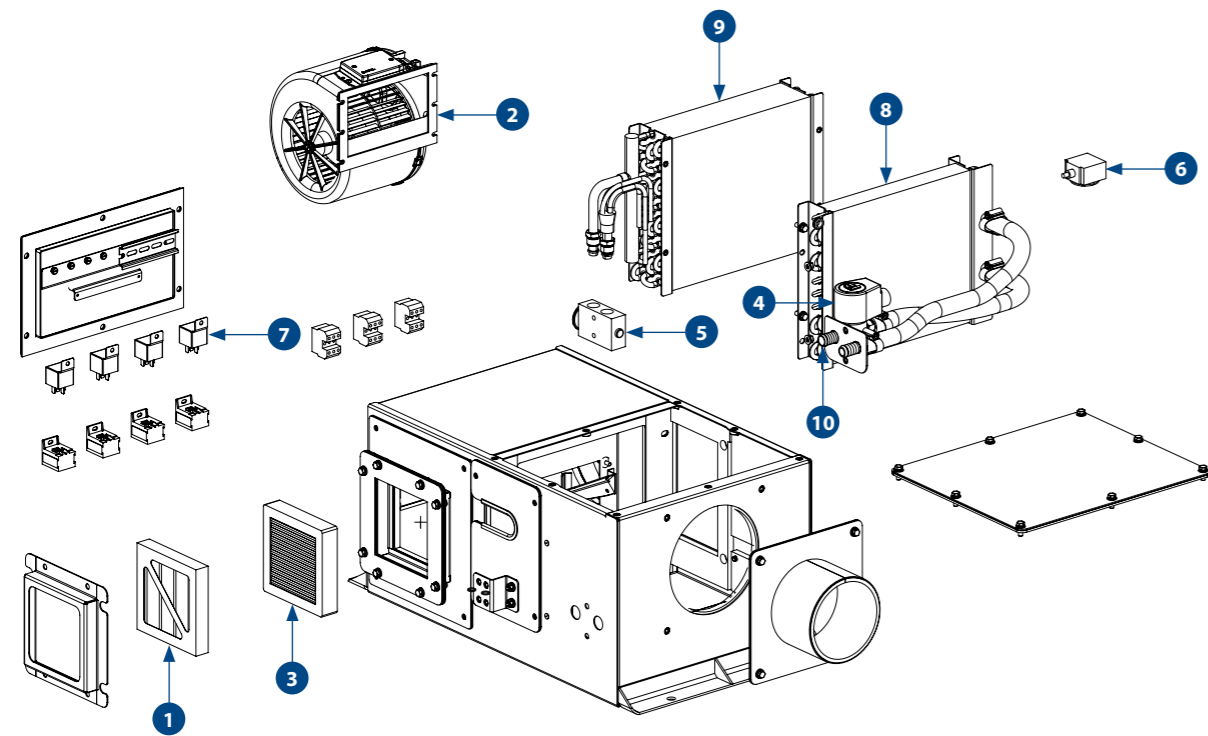
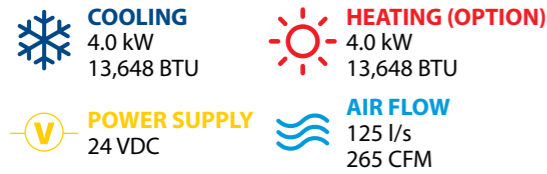

SPARE PARTS

PART NO.	DESCRIPTION	QTY
1 AU4601021	FILTER PLEATED 30/30 130MM X 130MM X 22MM	1
2 AU4301014	FAN DECK	1
3 AU4601020	FILTER HEPA 95% EFF 130MM X 130MM X 27MM	1
4 UE057	SOLENOID VALVE 24VDC 1/4BSP WATER	1
5 H0081856	TX VALVE BLK PARKER 2T R134A	1
6 UE016	THERMOSTAT DEICE STUD	1
7 H0076255	RELAY 24V 40A-DIODE PROTECTED	4
8 AU1301002	HEATER COIL 250MM X 228MM X 33MM 2ROW	1
9 AU1201014	EVAPORATOR COIL 250MM X 228MM X 66MM 4ROW	1
10 UC096	FTG P3 5/8 STR BRB x 1/4 MBSPT	1
UC022	KNOB SNOWFLAKE 6.35mm	1

SPECIFICATIONS

	METRIC	IMPERIAL
Cooling Capacity	4.0kW	13,648 BTU
Heating Capacity	4.0 kW	13,648 BTU
Fan Speeds	3	3
Air Flow	125 l/s	265 CFM
Fresh Air	10 l/s	21 CFM
Power Supply	24 VDC	24 VDC
Current Draw	20 A	20 A
Refrigerant	R134a	R134a
Maximum Ambient Temperature	54°C	129°F
Weight (nominal)	30.0 Kg	66.0 lbs
Technical Manual	SM510-4044	SM510-4044
Dimension (L X W X H)	640 mm X 350 mm X 295 mm	25.2 in X 13.8 in X 11.6 in

MAINTENANCE

MONTHLY / 400 HOURS

AU4601021	FILTER PLEATED 30/30 130 X 130 X 22MM
-----------	---------------------------------------

ANNUAL / 4,800 HOURS

AU4301014	FAN DECK
AU4601020	FILTER HEPA 95% EFF 130MM X 130MM

3 YEARS / 14,400 HOURS

UE057	SOLENOID VALVE 24VDC 1/4BSP WATER
H0081856	TX VALVE BLK PARKER 2T R134A
UE016	THERMOSTAT DEICE STUD
H0076255	RELAY 24V 40A-DIODE PROTECTED

COMPANION ITEMS





PART NO.	DESCRIPTION
TCW5BX1	Electric Condenser (Captive O-Ring)
TCW5BX2	Electric Condenser (Standard O-Ring)
FVV40	Pressuriser
H0404763	Hydraulic Driven Compressor 150 (Vertical)
H0081855	Receiver Drier
KNHV90043	TX Valve Fitting Kit
KNHV90044	R/A Box Duct Kit
AU531422	Receiver Drier
H0023631	Return Air Box - 6 (BX1)
AS4044301	Return Air Duct - 5 (BX2)
H0037067	FILTER - OPTIONAL (for H0023631)
AU679519	CONTROLLER ELECTRONIC 24VDC DISPLAY
H0136099	MANUAL CONTROLLER (for BX1)
H0004773	CONT PANEL WELD ASSY (for BX2, holds 3 AU679519)
H0005892	CONT PANEL WELD ASSY (for BX1, holds 1 AU679519)

TFR7

ROOFTOP EVAPORATOR

TFR7BX2

7kW 24V Evaporator with Heating (6kW)

	COOLING 7.0 kW 23,884 BTU		HEATING (OPTION) 6.0 kW 20,472 BTU
	POWER SUPPLY 24 VDC		AIR FLOW 170 l/s 360 CFM

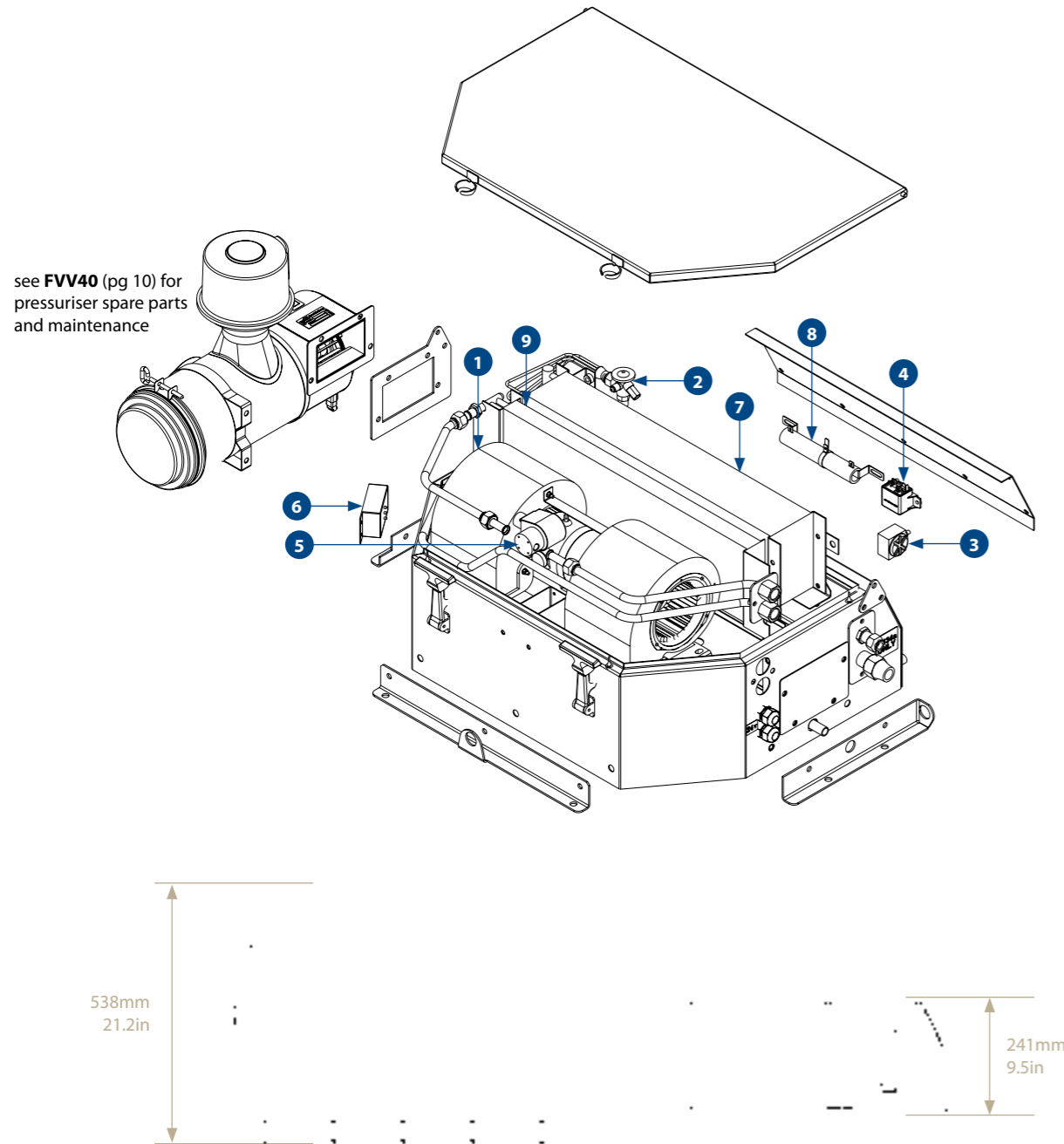

SPARE PARTS

PART NO.	DESCRIPTION	QTY
1	AS500037 SUPPLY FAN ASSEMBLY	1
	AU320C053 MOTOR 3450-263 27VDC D/S	1
	UF171 BLOWER 121D X 127W X 3/8" DI	2
	UF173 BLOWER HOUSING LEFT HAND	1
	UF174 BLOWER HOUSING RIGHT HAND	1
	AU320028 MOTOR BRUSH KIT - ASSEMBLY + HOLDER (2x BRUSH)	1
	AU410902 INLET RING 105MM (Previously UF034)	2
2	AU521509 TX VALVE 2T 3/8" IN 1/2" OUT 1/4" EQ R134A	1
	AU521508 TX ORIFICE 2T R22 #06	1
3	UE016 THERMOSTAT DEICE STUD	1
4	AU661487 RELAY 50A 24VDC 1 POLE	1
5	UE057 VALVE SOLENOID 1/4" BSP 24VDC WATER	1
6	AU681925 THERMOSTAT 12-24VDC WITH SENSOR + POT	1
7	AU120954 EVAPORATOR COIL 570MM X 152MM X 95MM 6RW	1
8	AU692105 RESISTOR 2 OHM 100W 1 CLIPS ADJUSTABLE	1
9	AU130014 HEATER COIL 570 X 152 X 32 2RW TFR6BX2	1
	H0482198 RETURN AIR FILTER MEDIA	1
	MC0445 RETURN AIR FILTER ASSEMBLY E&T SERIES	1
	AU862213 SEAL RUBBER	3
	AU851590 TOGGLE CLAMP RUBBER	2
	AU641065 CIRCUIT BREAKER 25A PUSH PULL	1
	AU641C110 CIRCUIT BREAKER 15A PUSH PULL	1
	AU821300 DIFFUSER ROUND 120MM POLYAMIDE	4
	AU523365 LP SWITCH 1/4" FF 205kPa	1
	AU641C111 CIRCUIT BREAKER 5A PUSH PULL	2
	AU663563 ROTARY SWITCH FAN	1
	AU663569 ROTARY SWITCH MODE	1
	UR008 BULKHEAD FITTING 1/2" MF,	1
	UC504 DRAIN NOZZLE 13mm	4

SPECIFICATIONS

	METRIC	IMPERIAL
Cooling Capacity	7.0 kW	23,884 BTU
Heating Capacity	6.0 kW	20,472 BTU
Fan Speeds	3	3
Air Flow	170 l/s	360 CFM
Fresh Air	30 l/s	64 CFM
Power Supply	24 VDC	24 VDC
Current Draw	13.5 A	13.5 A
Refrigerant	R134a	R134a
Maximum Ambient Temperature	54°C	129°F
Weight (nominal)	80.0 Kg	176.0 lbs
Technical Manual	SM395-5000	SM395-5000
Dimension (L X W X H)	734 mm X 538 mm X 241 mm	28.9 in X 21.2 in X 9.5 in

MAINTENANCE

MONTHLY / 400 HOURS

MC0445	RETURN AIR FILTER ASSEMBLY E&T SERIES
H0482198	RETURN AIR FILTER MEDIA

6 MONTHS / 2,400 HOURS

AU320028	MOTOR BRUSH KIT - ASSEMBLY + HOLDER
----------	-------------------------------------

ANNUAL / 4,800 HOURS

AU320C053	MOTOR 3450-263 27VDC D/S
-----------	--------------------------

3 YEARS / 14,400 HOURS

AU521509	TX VALVE 2T 3/8" IN 1/2" OUT 1/4" EQ R134A
AU521508	TX ORIFICE 2T R22 #06
UE016	THERMOSTAT DEICE STUD
AU661487	RELAY 50A 24VDC 1 POLE
UE057	VALVE SOLENOID 1/4" BSP 24VDC WATER
AU681925	THERMOSTAT 12-24VDC WITH SENSOR + POT
AU862213	SEAL RUBBER

COMPANION ITEMS

PART NO.	DESCRIPTION
TCF7BX2	Electric Condenser
H0404765	Hydraulic Compressor 170 (Vertical)
H0404764	Hydraulic Compressor 170 (Horizontal)
AU1102401	Radiator Condenser
AU270306	Engine Driven Compressor
AU270307	Engine Driven Compressor
AU270311	Engine Driven Compressor
AU270312	Engine Driven Compressor
AU531411	Receiver Drier
AU531422	Receiver Drier