

M SERIES

SIGMA M SERIES air conditioners are designed to provide a climate controlled, conditioned space for drag lines, crane operator cabins, switch rooms and other applications where heavy shock load, vibration and dust saturated corrosive environments are experienced.

SIGMA M-Series systems are designed to meet applications of high cooling/heating capacities at high ambient, up to 50°C, with high levels of reliability and serviceability.

MODEL	PAGE
MPF6MX11 (H0550437)	50
MPR9MX1	52 - 59
M9 MX1 EVAPORATOR	52
M9 MX1 CONDENSER	54
M9 MX1 PREVIOUS ELECTRICAL	56
M9 MX1 CURRENT ELECTRICAL	58
MPR9VX1	60 - 65
M9 VX1 EVAPORATOR	60
M9 VX1 CONDENSER	62
M9 VX1 ELECTRICAL	64
MPR25MX1	66 - 73
M25 MX1 EVAPORATOR	66
M25 MX1 CONDENSER	68
M25 MX1 ELECTRICAL	70
MPV5MX2	72
MPW5MX1	74 - 77
MPW5 REFRIGERATION / GENERAL ASSEMBLY	74
MPW5 ELECTRICAL	76



MPF6MX11

FLOOR MOUNTED UPRIGHT HVAC UNIT

H0550437

Floor Mounted Upright Packaged HVAC 6kW 415VAC without Pressuriser



COOLING
6.0 kW
20,472 BTU

AIR FLOW
270 l/s
572 CFM

POWER SUPPLY
415 VAC
3 phase - 50Hz

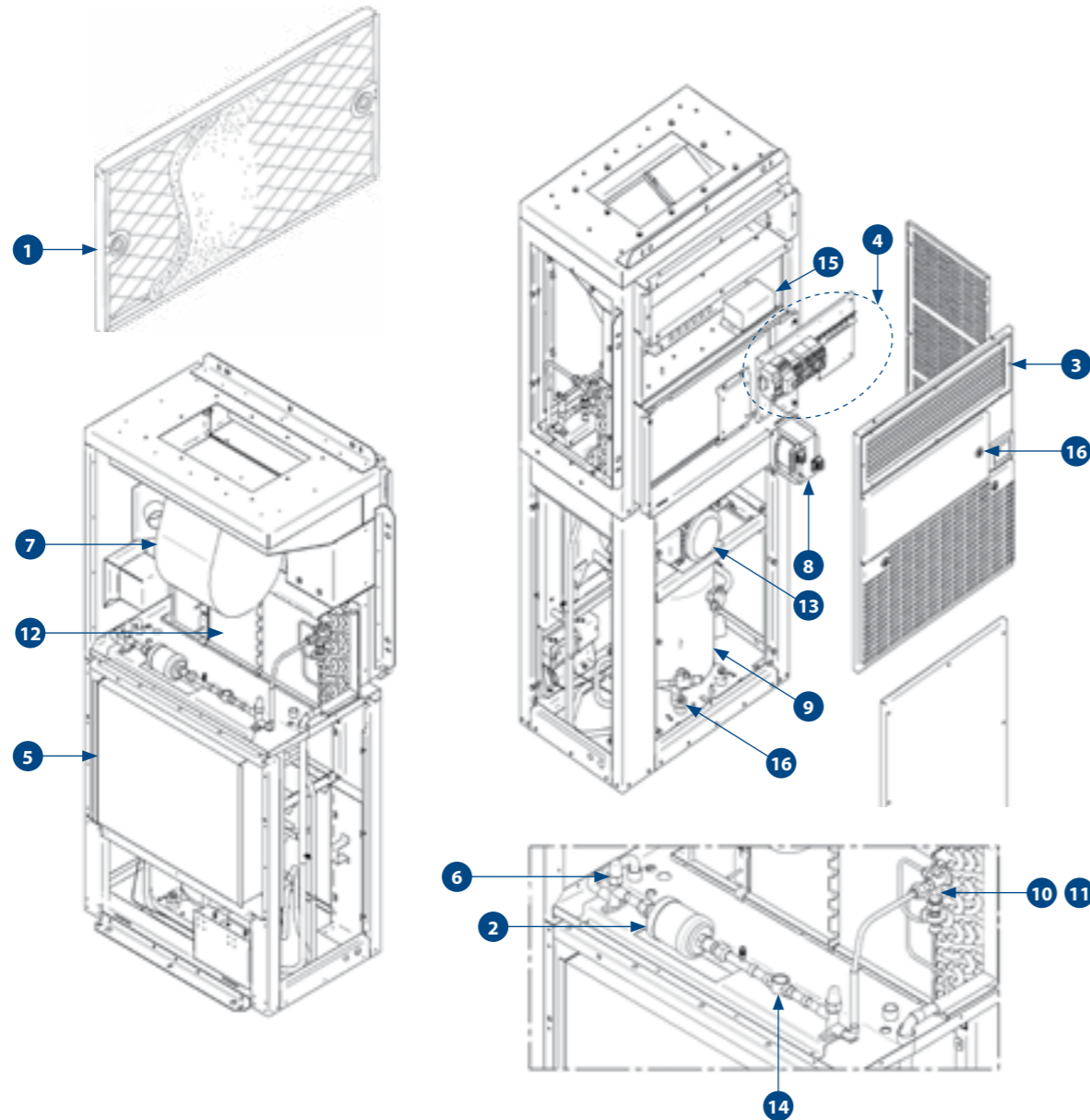

SPARE PARTS

PART NO.	DESCRIPTION	QTY
1 AS242745 S2427088	RETURN AIR FILTER ASSY RETURN AIR MEDIA FOR AS242745	1 1
2 AU531358	DRIER 5/8" MF	1
3 AU821136	LOUVRE 646MM X 136MM OPEN AREA DOUBLE DEFLECT	1
AU641390 4 AU641496 AU651303	CIRCUIT BREAKER 4A 2 POLE CIRCUIT BREAKER 11.0-16.0A 3 POLE CONTACTOR 9A 240VAC 3 POLE 1NO 1NC	1 1 2
5 AU110429	CONDENSER COIL 600 X 508 X 110 4RW MPF	1
6 H0124652	CAPPED LINE VALVE, 5/8"	2
7 AU410503	BLOWER ASSEMBLY 240V 50HZ	1
8 AU666026	TRANSFORMER 415V 240V 24V 500VA	1
9 H0096689	VERTICAL SCROLL COMPRESSOR	1
10 AU521505	TX ORIFICE 2T R22 #05	1
11 AU521509	TX VALVE 2T 3/8" IN 1/2" OUT 1/4" EQ R134A	1
12 AU120284	EVAPORATOR COIL 610MM X 318MM X 110MM 4RW	1
13 AU310214	MOTOR 0.75KW 80P FT 4P	1
14 AU533556	LMI 5/8" SOLDER	1
15 H0150820	THERMOSTAT CONTROL KIT	1
16 AU845248	ANTI VIBRATION MOUNT	4
AU851566	LATCH 1/4 TURN	3
AU420252	FAN AXIAL 400MM 9 BLADES	1
AU862213	SEAL RUBBER	1

SPECIFICATIONS

	METRIC	IMPERIAL
Cooling Capacity	6.0 kW	20,472 BTU
Fan Speeds	3	3
Air Flow	270 l/s	572 CFM
Power Supply	415 VAC / 50Hz 3 Phase	415 VAC / 50Hz 3 Phase
Current Draw	12A	12A
Refrigerant	R134a	R134a
Maximum Ambient Temperature	54°C	129°F
Weight (nominal)	295.0 Kg	649.0 lbs
Technical Manual Reference	SM408-2427	SM408-2427
"Dimension (L X W X H)"	1512 mm X 1145 mm X 970 mm	59.5 in X 45.1 in X 38.2 in

MAINTENANCE

MONTHLY / 450 HOURS

AS242745	RETURN AIR FILTER ASSY
S2427088	RETURN AIR MEDIA for AS242745

ANNUAL / 5,400 HOURS

AU531358	DRIER 5/8" MF
----------	---------------

3 YEARS / 16,200 HOURS

AU521509	TX VALVE 2T 3/8" IN 1/2" OUT 1/4" EQ R134A
AU521505	TX ORIFICE 2T R22 #05

COMPANION ITEMS

PART NO.	DESCRIPTION
FV50M1	Pressuriser

Please be advised, the following items may be required while replacing compressor **H0096689**:

- H0070195 COMP BLANK ASSY - 7/8
- H0070197 COMP BLANK TUBE - 3/8
- AU845248 ANTI VIB MNT 17/409-45 (4 qty)







MPR9MX1 EVAPORATOR

ROOFTOP PACKAGED HVAC UNIT

MPR9MX1

10kW 380/415/460 VAC with Heating (12kW)

	COOLING 10.0 kW 34,120 BTU		HEATING (OPTION) 12.0 kW 40,944 BTU
	POWER SUPPLY 380/415/460 VAC 3 phase 50/60Hz		AIR FLOW 610 l/s 1,293 CFM

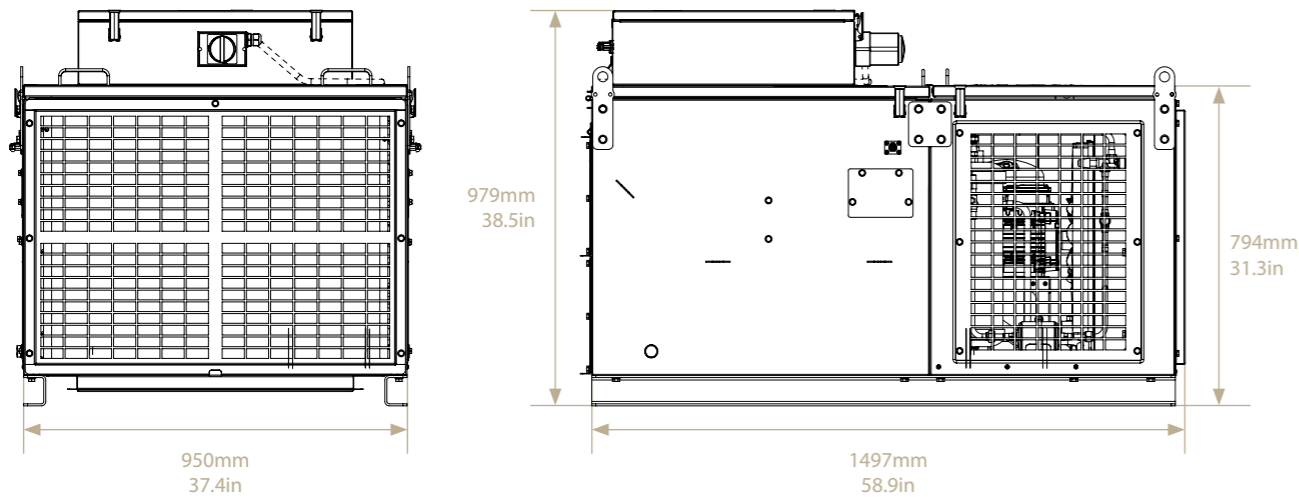
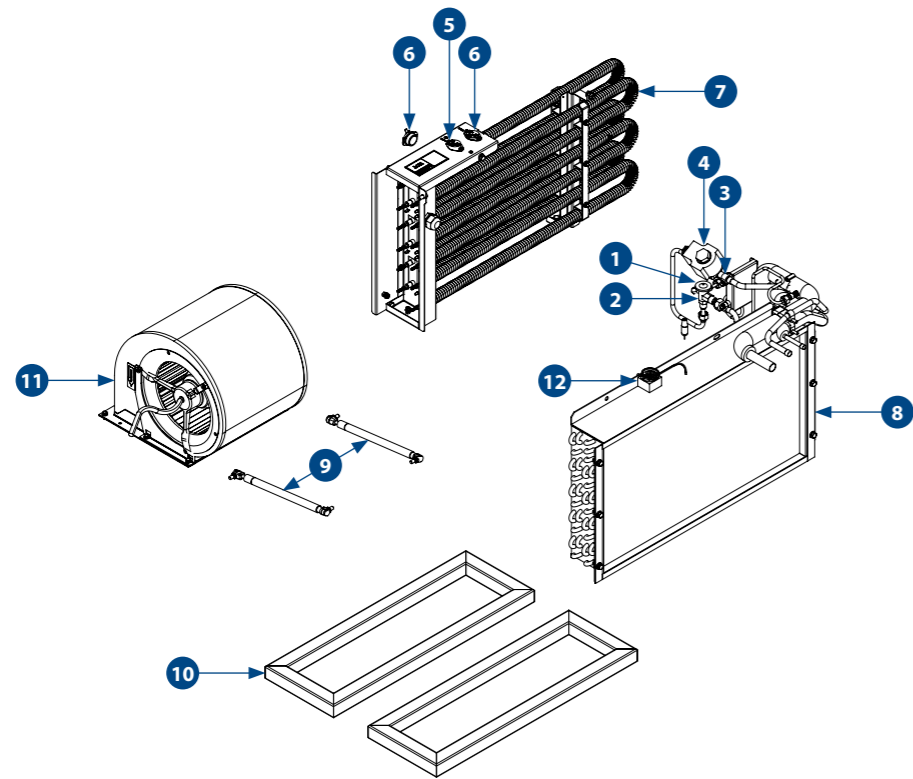

SPARE PARTS

PART NO.	DESCRIPTION	QTY
1	AU521508 TX ORIFICE 2T R22 #06	1
2	AU521509 TX VALVE 2T 3/8"IN 1/2"OUT 1/4"EQ R134a	1
3	AU522042 SOLENOID VALVE 1/2" SOLDER NC	1
4	AU668140 COIL SOLENOID 24VDC TYPE 1	1
5	AU681009 THERMOSTAT HOT2	1
6	AU6811013 THERMOSTAT HOT1 & HHS	2
7	AU691C041 HEATER ELEMENT 277V 2500W	6
8	H0070297 EVAPORATOR COIL	1
9	H0080806 GAS STRUT	2
10	H0080812 RA / SA OPENING SEAL	2
11	H0082201 SUPPLY AIR FAN ASSY	1
12	UE016 THERMOSTAT DEICE STUD MTG	1
AU862211	SEAL RUBBER	4.5m

SPECIFICATIONS

	METRIC	IMPERIAL
Cooling Capacity	10.0 kW	34,120 BTU
Heating Capacity	12.0 kW	40,944 BTU
Fan Speeds	2	2
Air Flow	610 l/s	1,293 CFM
Fresh Air	22 l/s	47 CFM
Power Supply	380/415/460 VAC 3 Phase, 50/60Hz	380/415/460 VAC 3 Phase, 50/60Hz
Current Draw	31 A	31 A
Refrigerant	R134a	R134a
Minimum Ambient Temperature	-10°C	14°F
Maximum Ambient Temperature	54°C	129°F
Weight (nominal)	457.0 Kg	1005.4 lbs
Technical Manual Reference	HD0031057	HD0031057
Dimension (L X W X H)	1497 mm X 950 mm X 979 mm	58.9 in X 37.4 in X 38.5 in

MAINTENANCE

3 YEARS / 16,200 HOURS

UE016	THERMOSTAT DEICE STUD
AU521509	TX VALVE 2T 3/8"IN 1/2" OUT 1/4"EQ R134A
AU521508	TX ORIFICE #06
AU862211	SEAL RUBBER

COMPANION ITEMS

PART NO.	DESCRIPTION
AS2134155S	RETURN AIR FILTER ASSEMBLY
H0082092	RETURN AIR FILTER ASSEMBLY COIL MOUNT
FVV40	Pressuriser 24V
H0146199	Adapter Frame Assembly
H0107836	Supply Air Damper Assembly
H0184867	Air Duct Front Panel
H0082091	RA Filter Assembly - Coil Mount MPR9
H0087360	Spigot Supply Air M9 (152-203)
H0099206	Spigot Return Air M9 (152-203)
H0099206	Supply Air Plenum Assembly
H0099206	Return Air Plenum C/W Filter







MPR9MX1

CONDENSER

ROOFTOP PACKAGED HVAC UNIT

MPR9MX1

10kW 380/415/460 VAC with Heating (12kW)

	COOLING 10.0 kW 34,120 BTU		HEATING (OPTION) 12.0 kW 40,944 BTU
	POWER SUPPLY 380/415/460 VAC 3 phase 50/60Hz		AIR FLOW 610 l/s 1,293 CFM

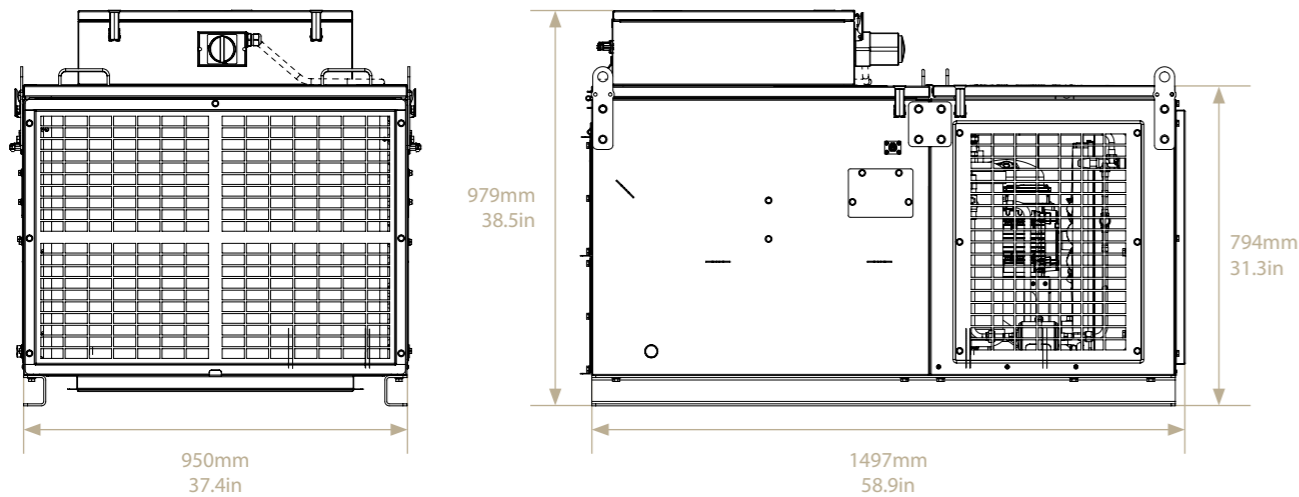
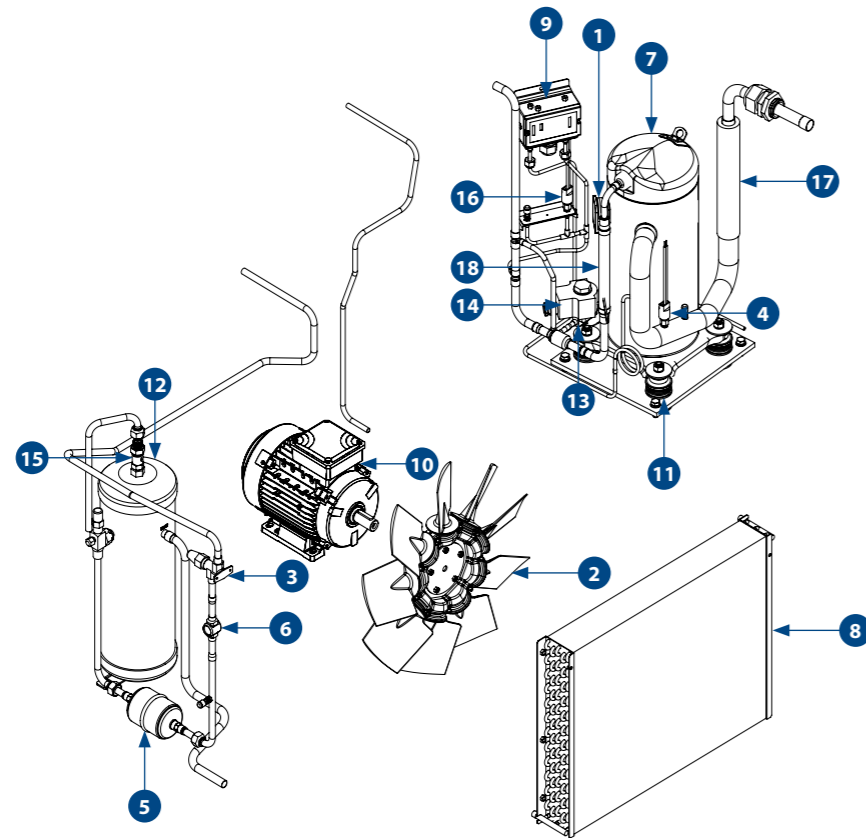

SPARE PARTS

PART NO.	DESCRIPTION	QTY
1	AU230818 COMPRESSOR LEAD Previously AU230818	1
2	AU420157 CONDENSER FAN	1
3	AU517256 PCAV 1/2" SOLDER	1
4	H0152017 LOW PRESSURE CONTROL	1
5	AU531356 LIQUID LINE FILTER	1
6	AU533136 LIQUID MOISTURE INDICATOR	1
7	652A20006 COMPRESSOR	1
8	H0072613 CONDENSER COIL	1
9	AU523112 DUAL PRESSURE CONTROL LP AUTO HP AUTO	1
10	H0080329 CONDENSER FAN MOTOR	1
11	H0103172 VIBRATION MOUNT	4
12	AU160C012 RECEIVER LIQUID VERT 6X18 MP	1
13	AU522021 SOLENOID VALVE 3/8" SOLDER NC	1
14	AU668140 COIL SOLENOID 24VDC TYPE 1	1
15	AU527126 RELIEF VALVE 3/8" MNPT x 2.7MPa	1
16	H0148597 HIGH PRESSURE CONTROL	1
17	H0080748 VIBRATION ELIMINATOR (SUCTION)	1
18	H0080749 VIBRATION ELIMINATOR (DISCHARGE)	1
	AU542026 REFRIGERANT OIL	1

SPECIFICATIONS

	METRIC	IMPERIAL
Cooling Capacity	10.0 kW	34,120 BTU
Heating Capacity	12.0 kW	40,944 BTU
Fan Speeds	2	2
Air Flow	610 l/s	1,293 CFM
Fresh Air	22 l/s	47 CFM
Power Supply	380/415/460 VAC 3 Phase, 50/60Hz	380/415/460 VAC 3 Phase, 50/60Hz
Current Draw	31 A	31 A
Refrigerant	R134a	R134a
Minimum Ambient Temperature	-10°C	14°F
Maximum Ambient Temperature	54°C	129°F
Weight (nominal)	457.0 Kg	1005.4 lbs
Technical Manual Reference	HD0031057	HD0031057
Dimension (L X W X H)	1497 mm X 950 mm X 979 mm	58.9 in X 37.4 in X 38.5 in

MAINTENANCE

ANNUAL / 5,400 HOURS

AU531356 LIQUID LINE FILTER

3 YEARS / 16,200 HOURS

H0152017 LOW PRESSURE CONTROL

H0148597 HIGH PRESSURE CONTROL

AU542026 REFRIGERANT OIL

AU523112 DUAL PRESSURE CONTROL

Please contact SIGMA for more information including details on an overhaul scope and interval. Maintenance periods and scope are dependent on application and site conditions, and are to be used as a guide.



MPR9MX1

PREVIOUS ELECTRICAL (serial no. 100031 & under)
ROOFTOP PACKAGED HVAC UNIT

MPR9MX1

10kW 380/415/460 VAC with Heating (12kW)



- COOLING**
10.0 kW
34,120 BTU
- HEATING (OPTION)**
12.0 kW
40,944 BTU
- POWER SUPPLY**
380/415/460 VAC
3 phase 50/60Hz
- AIR FLOW**
610 l/s
1,293 CFM

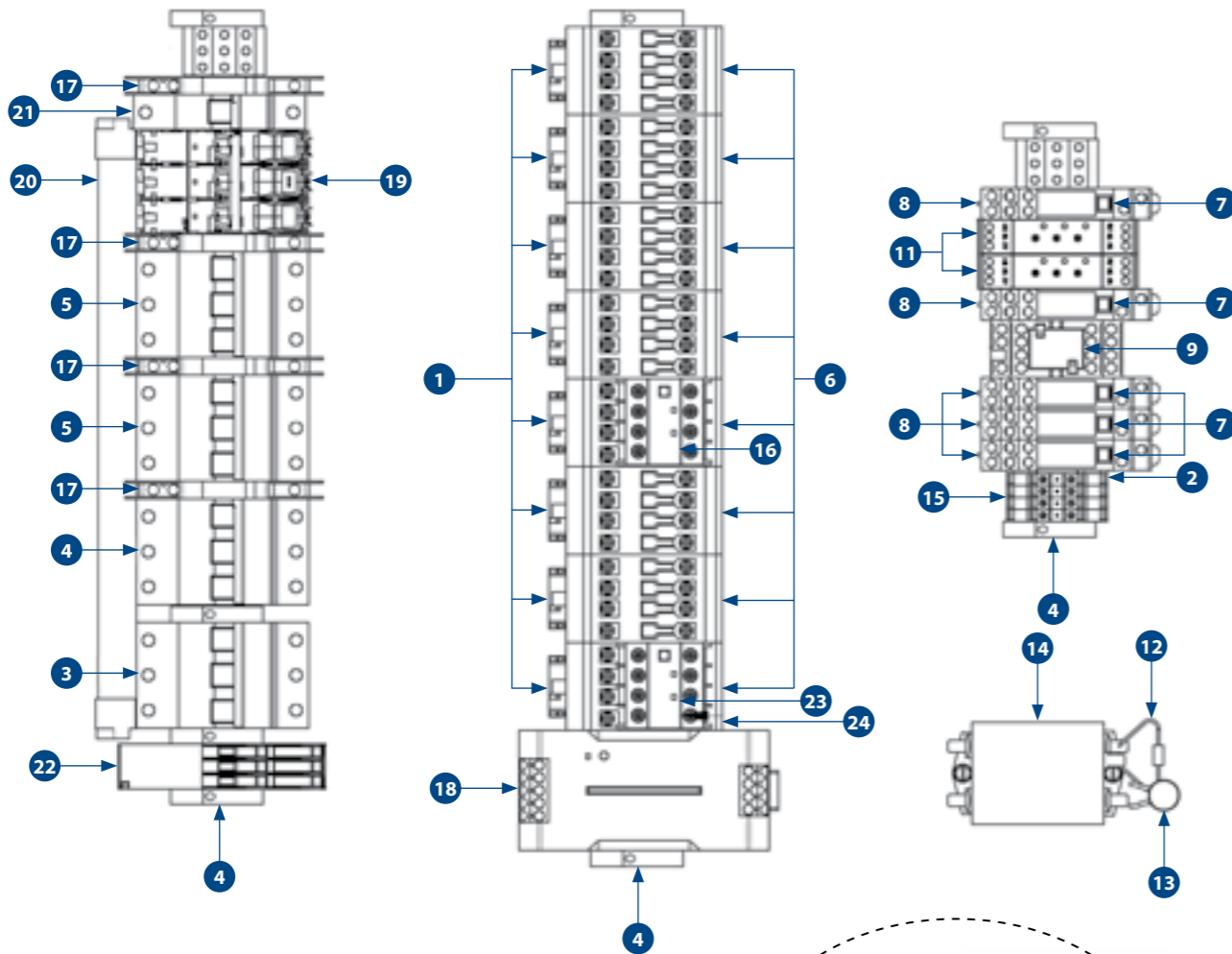

see **H0134546** (pg 101) or **H0082302** (pg 102)
for control spare parts and maintenance

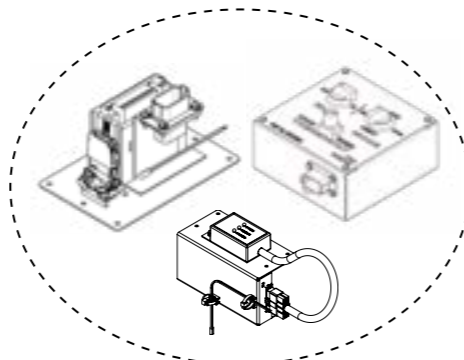

SPARE PARTS

PART NO.	DESCRIPTION	QTY
1	642E058 SURGE SUPPRESSOR	8
2	AU635446 END PLATE	1
3	AU641332 3A CIRCUIT BREAKER	1
4	AU641336 16A CIRCUIT BREAKER	1
5	AU641337 6A CIRCUIT BREAKER	2
6	AU651544 CONTACTOR	7
7	AU661040 24V 2 POLE RELAY	5
8	H0343830 RELAY BASE 8 PIN Previously AU661041	5
9	AU661044 24V 4 POLE RELAY	1
10	AU661045 RELAY BASE	1
11	AU672500 MULTIFUNCTION TIMER	2
12	AU674022 SUPPRESSOR DIODE	1
13	AU674040 25VAC VARISTOR	1
14	AU674101 SUPPRESSION FILTER	1
15	AU674401 DIODE TERMINAL BLOCK	4
16	H0082714 AUXILIARY CONTACTOR	1
17	H0082715 AUXILIARY CONTACT CB	4
18	H0082717 240W POWER SUPPLY	1
19	H0093336 ABB CIRCUIT BREAKER	1
20	H0100159 BUSBAR	1
21	H0610964 SHUNT TRIP Previously AU641330	1
22	H0170133 PHASE DETECTION RELAY	1
23	642B20039 AUXILIARY CONTACT	1
24	H0060331 CONTACTOR	1
TTP5322	MECHANICAL INTERLOCK	2
AU862211	SEAL RUBBER	2.5m

SPECIFICATIONS

	METRIC	IMPERIAL
Cooling Capacity	10.0 kW	34,120 BTU
Heating Capacity	12.0 kW	40,944 BTU
Fan Speeds	2	2
Air Flow	610 l/s	1,293 CFM
Fresh Air	22 l/s	47 CFM
Power Supply	380/415/460 VAC 3 Phase, 50/60Hz	380/415/460 VAC 3 Phase, 50/60Hz
Current Draw	31 A	31 A
Refrigerant	R134a	R134a
Minimum Ambient Temperature	-10°C	14°F
Maximum Ambient Temperature	54°C	129°F
Weight (nominal)	457.0 Kg	1005.4 lbs
Technical Manual Reference	HD0031057	HD0031057
Dimension (L X W X H)	1497 mm X 950 mm X 979 mm	58.9 in X 37.4 in X 38.5 in

COMPANION ITEMS

PART NO.	DESCRIPTION
H0134546	Manual Control Unit
H0082302	Electronic Control Unit
H0264933	Custom Operators Seat Control Option

Please contact SIGMA for more information including details on an overhaul scope and interval.
Maintenance periods and scope are dependent on application and site conditions, and are to be used as a guide.







MPR9MX1

CURRENT ELECTRICAL (serial no. 100035 onwards)

ROOFTOP PACKAGED HVAC UNIT

MPR9MX1

10kW 380/415/460 VAC with Heating (12kW)

	COOLING 10.0 kW 34,120 BTU		HEATING (OPTION) 12.0 kW 40,944 BTU
	POWER SUPPLY 380/415/460 VAC 3 phase 50/60Hz		AIR FLOW 610 l/s 1,293 CFM

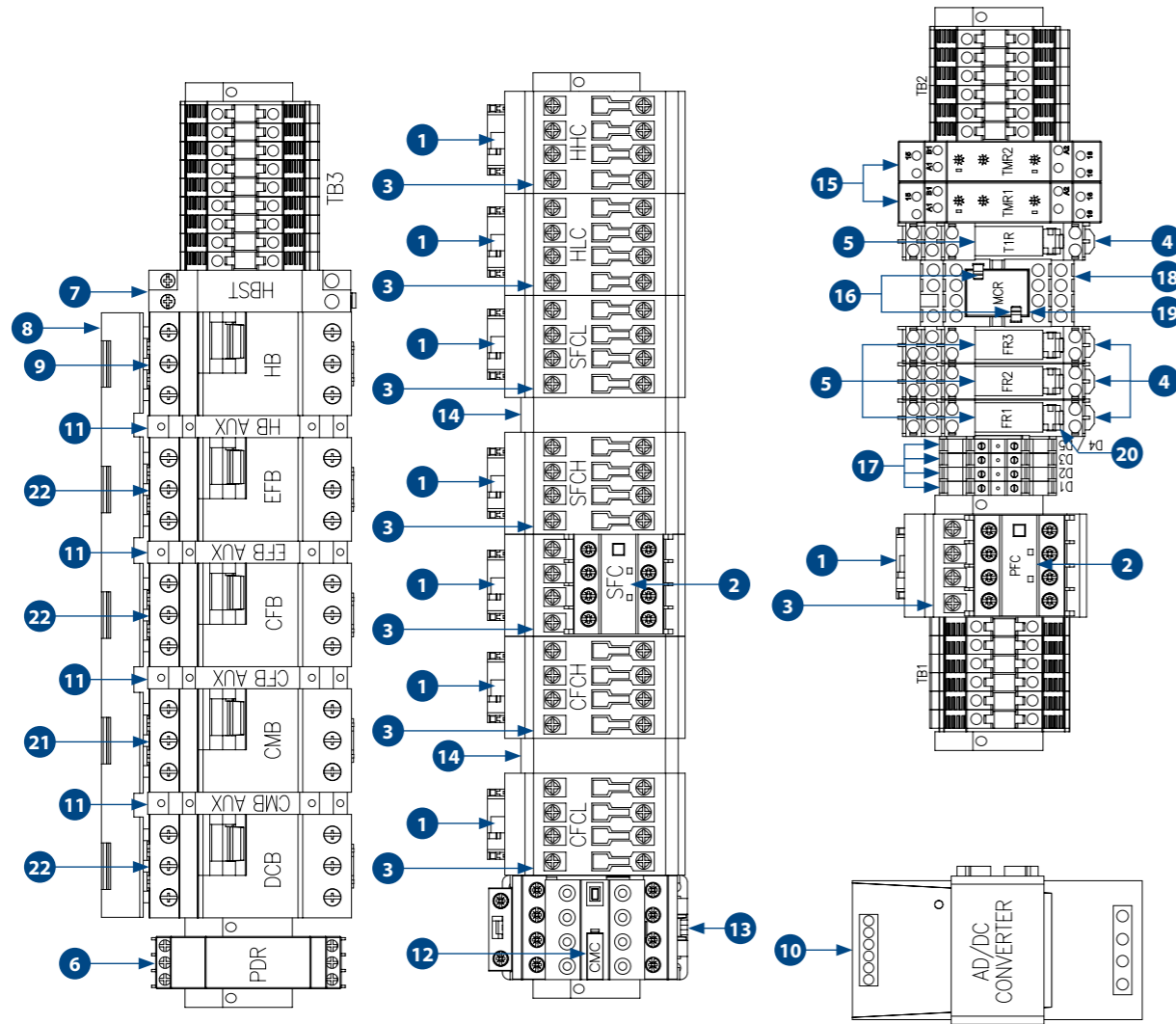

see **H0134546** (pg 101) or **H0082302** (pg 102) for control spare parts and maintenance

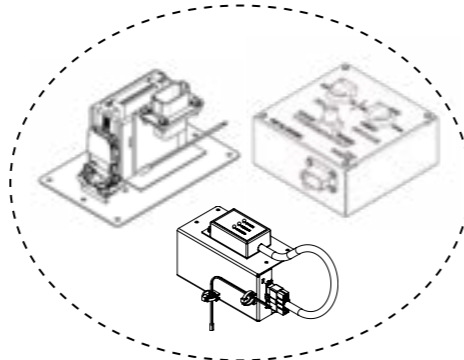

SPARE PARTS

PART NO.	DESCRIPTION	QTY
1	642E058 SURGE SUPPRESSOR	8
2	H0082714 AUX CONTACT SFC/PFC	2
3	AU651544 CONTACTOR	8
4	H0343830 RELAY, BASE FOR 8 PIN G2R	4
5	AU661040 RELAY 8 PIN 24VDC 2 POLES	4
6	H0249468 PHASE DETECTION RELAY	1
7	H0236005 SHUNT TRIP, 380-400VAC 50HZ	1
8	H0222341 BUSBAR	1
9	H0222339 CIRCUIT BREAKER	1
10	H0222338 CONVERTER	1
11	AU641454 CIRCUIT BREAKER AUX 1NO 1NC	4
12	642B20039 AUX. CONTACT - CMC	1
13	H0060331 CONTACTOR	1
14	TTP5322 INTERLOCK	2
15	AU672500 TIMER ON DELAY 24VDC 0.1SEC-100HR 1 POLE	2
16	AU661046 RLY CLIPS FOR MY4N	2
17	AU674401 DIODE TERM BLOCK COMMON CATHOD	4
18	AU661045 RLY BASE FOR MY4N	1
19	AU661044 RLY OMRON 24VDC 4 POLES	1
20	AU635446 END PLATE	1
21	642M279 CIRCUIT BREAKER	1
22	642M076 CIRCUIT BREAKER	3
	AU862211 SEAL RUBBER	2.5m

SPECIFICATIONS

	METRIC	IMPERIAL
Cooling Capacity	10.0 kW	34,120 BTU
Heating Capacity	12.0 kW	40,944 BTU
Fan Speeds	2	2
Air Flow	610 l/s	1,293 CFM
Fresh Air	22 l/s	47 CFM
Power Supply	380/415/460 VAC 3 Phase, 50/60Hz	380/415/460 VAC 3 Phase, 50/60Hz
Current Draw	31 A	31 A
Refrigerant	R134a	R134a
Minimum Ambient Temperature	-10°C	14°F
Maximum Ambient Temperature	54°C	129°F
Weight (nominal)	457.0 Kg	1005.4 lbs
Technical Manual Reference	HD0031057	HD0031057
Dimension (L X W X H)	1497 mm X 950 mm X 979 mm	58.9 in X 37.4 in X 38.5 in

COMPANION ITEMS

PART NO.	DESCRIPTION
H0134546	Manual Control Unit
H0082302	Electronic Control Unit
H0264933	Custom Operators Seat Control Option





Please contact SIGMA for more information including details on an overhaul scope and interval. Maintenance periods and scope are dependent on application and site conditions, and are to be used as a guide.



MPR9VX1 EVAPORATOR

ROOFTOP PACKAGED HVAC UNIT

MPR9VX1
10kW 460/575 VAC with Heating (12kW)

	COOLING 10.0 kW 34,120 BTU		HEATING (OPTION) 12.0 kW 40,944 BTU
	POWER SUPPLY 460/575 VAC 3 phase 50/60Hz		AIR FLOW 610 l/s 1,293 CFM

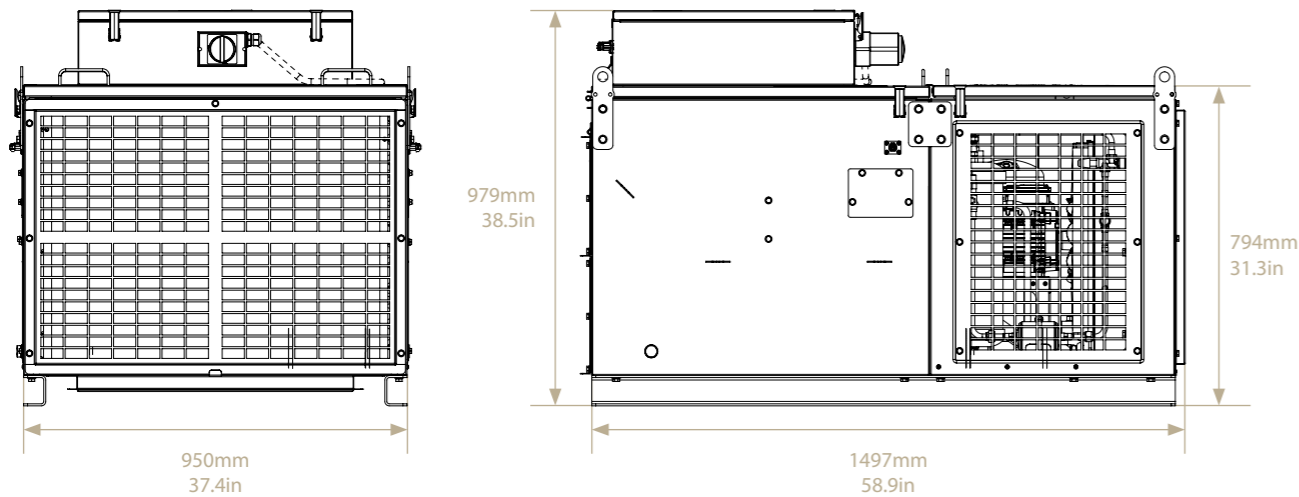
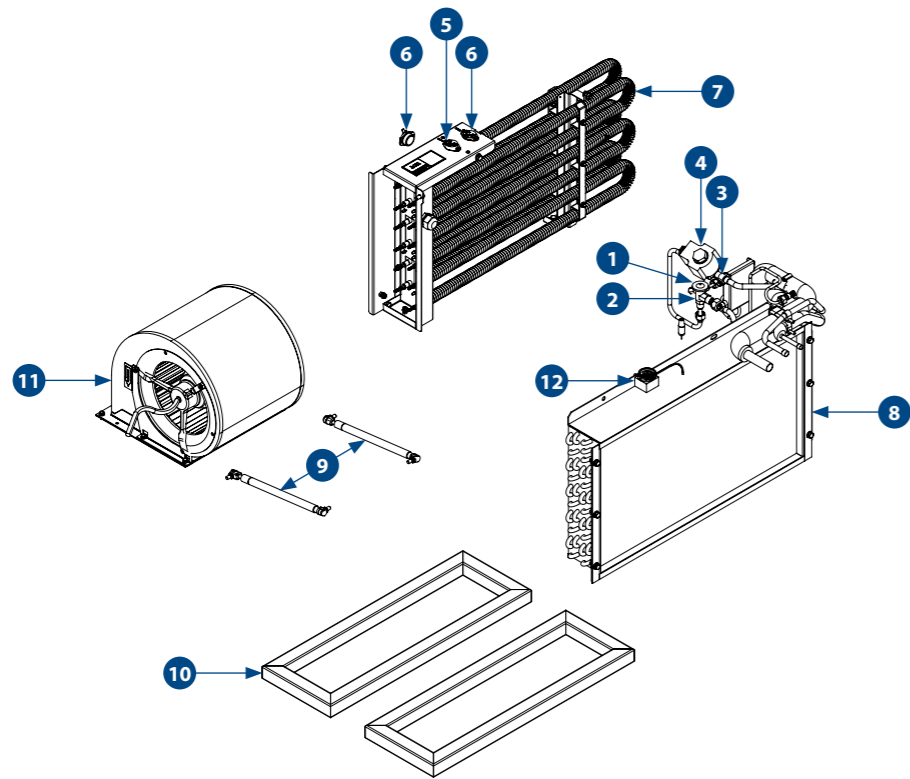

SPARE PARTS

PART NO.	DESCRIPTION	QTY
1	AU521508 TX ORIFICE 2T R22 #06	1
2	AU521509 TX VALVE 2T 3/8"IN 1/2"OUT 1/4"EQ R134a	1
3	AU522042 SOLENOID VALVE 1/2" SOLDER NC	1
4	AU668140 COIL SOLENOID 24VDC TYPE 1	1
5	AU681009 THERMOSTAT HOT2	1
6	AU6811013 THERMOSTAT HOT1 & HHS	2
7	AU691C291 HEATER ELEMENT 240V 2500W Previously AU691C041	6
8	H0070297 EVAPORATOR COIL	1
9	H0080806 GAS STRUT	2
10	H0080812 RA / SA OPENING SEAL	2
11	H0254032 SUPPLY AIR FAN ASSY Previously H0082201	1
12	UE016 THERMOSTAT DEICE STUD MTG	1
AU862211	SEAL RUBBER	2.5m

SPECIFICATIONS

	METRIC	IMPERIAL
Cooling Capacity	10.0 kW	34,120 BTU
Heating Capacity	12.0 kW	40,944 BTU
Fan Speeds	2	2
Air Flow	610 l/s	1,293 CFM
Fresh Air	22 l/s	47 CFM
Power Supply	460/575 VAC 3 Phase, 50/60Hz	460/575 VAC 3 Phase, 50/60Hz
Current Draw	32 A	32 A
Refrigerant	R134a	R134a
Minimum Ambient Temperature	-10°C	14°F
Maximum Ambient Temperature	54°C	129°F
Weight (nominal)	457.0 Kg	1005.4 lbs
Technical Manual Reference	HD0031057	HD0031057
Dimension (L X W X H)	1497 mm X 950 mm X 979 mm	58.9 in X 37.4 in X 38.5 in

MAINTENANCE

3 YEARS / 16,200 HOURS

UE016	THERMOSTAT DEICE STUD
AU521508	TX ORIFICE 2T R22 #06
AU521509	TX VALVE 2T 3/8"IN 1/2"OUT 1/4"EQ R134a
AU862211	SEAL RUBBER

COMPANION ITEMS

PART NO.	DESCRIPTION
AS2134155S	RETURN AIR FILTER ASSEMBLY
H0082092	RETURN AIR FILTER ASSEMBLY COIL MOUNT
FVV40	Right Hand Pressuriser Assembly 24V
H0146199	Adapter Frame Assembly
H0107836	Supply Air Damper Assembly
H0184867	Air Duct Front Panel
H0082091	RA Filter Assembly - Coil Mount MPR9
H0087360	Spigot Supply Air M9 (152-203)
H0099206	Spigot Return Air M9 (152-203)
H0099206	Supply Air Plenum Assembly
H0099206	Return Air Plenum C/W Filter



MPR9VX1





CONDENSER

ROOFTOP PACKAGED HVAC UNIT

MPR9VX1

10kW 460/575 VAC with Heating (12kW)



	COOLING 10.0 kW 34,120 BTU		HEATING (OPTION) 12.0 kW 40,944 BTU
	POWER SUPPLY 460/575 VAC 3 phase 50/60Hz		AIR FLOW 610 l/s 1,293 CFM

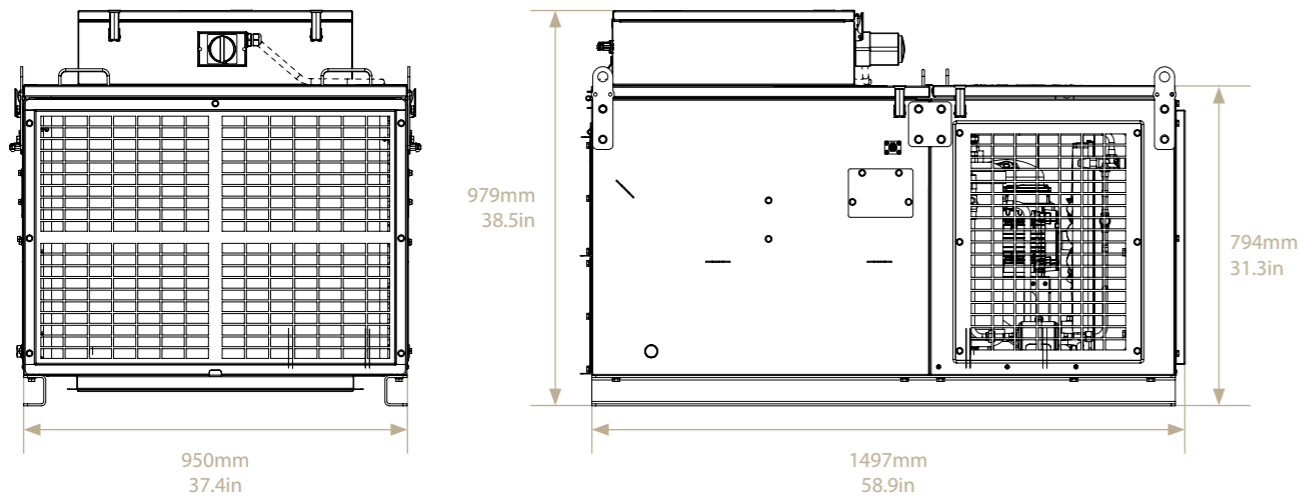
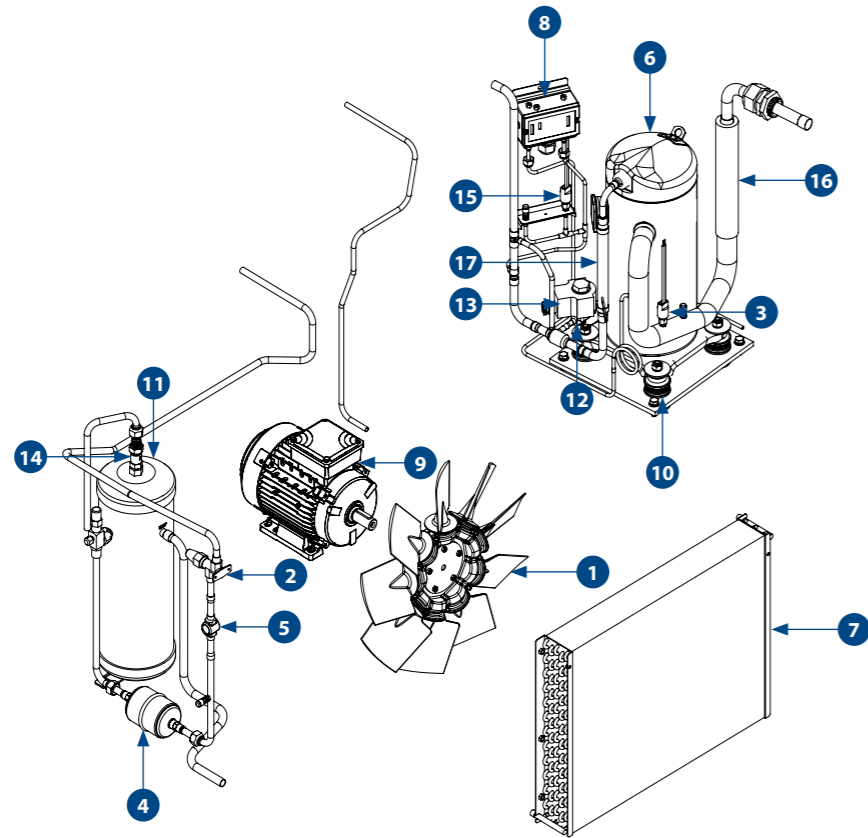

SPARE PARTS

PART NO.	DESCRIPTION	QTY
1	AU420157 CONDENSER FAN	1
2	AU517256 PCAV 1/2" SOLDER	1
3	H0152017 LOW PRESSURE CONTROL	1
4	AU531356 LIQUID LINE FILTER	1
5	AU533136 LIQUID MOISTURE INDICATOR	1
6	H0234959 COMPRESSOR	1
7	H0072613 CONDENSER COIL	1
8	AU523112 DUAL PRESSURE CONTROL LP AUTO HP AUTO	1
9	H0234437 CONDENSER FAN MOTOR	1
10	H0103172 VIBRATION MOUNT	4
11	AU160C012 RECEIVER LIQUID VERT 6X18 MP	1
12	AU522021 SOLENOID VALVE 3/8" SOLDER NC	1
13	AU668140 COIL SOLENOID 24VDC TYPE 1	1
14	AU527126 RELIEF VALVE 3/8" MNPT x 2.7MPa	1
15	H0148597 HIGH PRESSURE CONTROL	1
16	H0080748 VIBRATION ELIMINATOR (SUCTION)	1
17	H0080749 VIBRATION ELIMINATOR (DISCHARGE)	1
AU542026	REFRIGERANT OIL	1

SPECIFICATIONS

	METRIC	IMPERIAL
Cooling Capacity	10.0 kW	34,120 BTU
Heating Capacity	12.0 kW	40,944 BTU
Fan Speeds	2	2
Air Flow	610 l/s	1,293 CFM
Fresh Air	22 l/s	47 CFM
Power Supply	460/575 VAC 3 Phase, 50/60Hz	460/575 VAC 3 Phase, 50/60Hz
Current Draw	32 A	32 A
Refrigerant	R134a	R134a
Minimum Ambient Temperature	-10°C	14°F
Maximum Ambient Temperature	54°C	129°F
Weight (nominal)	457.0 Kg	1005.4 lbs
Technical Manual Reference	HD0031057	HD0031057
Dimension (L X W X H)	1497 mm X 950 mm X 979 mm	58.9 in X 37.4 in X 38.5 in

MAINTENANCE

ANNUAL / 5,400 HOURS

AU531356 LIQUID LINE FILTER

3 YEARS / 16,200 HOURS

H0152017 LOW PRESSURE CONTROL

H0148597 HIGH PRESSURE CONTROL

AU542026 REFRIGERANT OIL

AU523112 DUAL PRESSURE CONTROL

Please contact SIGMA for more information including details on an overhaul scope and interval. Maintenance periods and scope are dependent on application and site conditions, and are to be used as a guide.



MPR9VX1

ELECTRICAL

ROOFTOP PACKAGED HVAC UNIT

MPR9VX1

10kW 460/575 VAC with Heating (12kW)

COOLING
10.0 kW
34,120 BTU

HEATING (OPTION)
12.0 kW
40,944 BTU

POWER SUPPLY
460/575 VAC
3 phase 50/60Hz

AIR FLOW
610 l/s
1,293 CFM



see **H0134546** (pg 101) or **H0082302** (pg 102) for control spare parts and maintenance

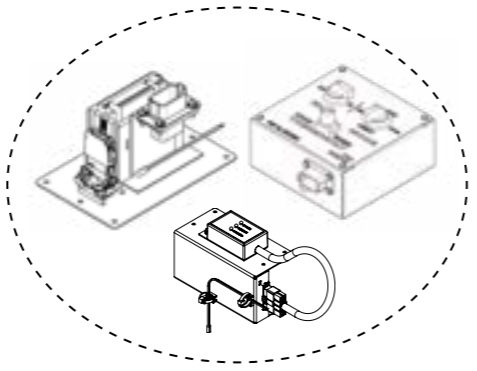

SPARE PARTS

PART NO.	DESCRIPTION	QTY
1	642E058 SURGE SUPPRESSOR	8
2	H0082714 AUXILIARY CONTACT SFC/PFC	2
3	AU651544 CONTACTOR	8
4	H0343830 RELAY, BASE FOR 8 PIN	5
5	AU661040 RELAY 8 PIN 24VDC 2 POLES	5
6	H0249468 PHASE DETECTION RELAY	1
7	H0222341 BUSBAR	1
8	H0222338 CONVERTER	1
9	AU641454 CIRCUIT BREAKER AUX 1NO 1NC	1
10	642B20039 AUXILIARY CONTACT - CMC	3
11	H0060331 CONTACTOR	1
12	TTP5322 INTERLOCK	1
13	AU672500 TIMER ON DELAY 24VDC 0.1SEC-100HR 1 POLE	2
14	AU661046 RLY CLIPS FOR MY4N	2
15	AU674401 DIODE TERM BLOCK COMMON CATHOD	2
16	AU661045 RLY BASE FOR MY4N	4
17	AU661044 RLY OMRON 24VDC 4 POLES	1
18	AU635446 END PLATE KLIPPON AP 3592 6 *	1
19	642M279 CIRCUIT BREAKER	1
20	H0095276 SHUNT TRIP	1
21	H0563803 CIRCUIT BREAKER 3P 20A	2
22	642E20014 AUXILIARY CONTACT	1
	AU862211 SEAL RUBBER	2.5m

SPECIFICATIONS

	METRIC	IMPERIAL
Cooling Capacity	10.0 kW	34,120 BTU
Heating Capacity	12.0 kW	40,944 BTU
Fan Speeds	2	2
Air Flow	610 l/s	1,293 CFM
Fresh Air	22 l/s	47 CFM
Power Supply	460/575 VAC 3 Phase, 50/60Hz	460/575 VAC 3 Phase, 50/60Hz
Current Draw	32 A	32 A
Refrigerant	R134a	R134a
Minimum Ambient Temperature	-10°C	14°F
Maximum Ambient Temperature	54°C	129°F
Weight (nominal)	457.0 Kg	1005.4 lbs
Technical Manual Reference	HD0031057	HD0031057
Dimension (L X W X H)	1497 mm X 950 mm X 979 mm	58.9 in X 37.4 in X 38.5 in

COMPANION ITEMS

PART NO.	DESCRIPTION
H0134546	Manual Control Unit
H0082302	Electronic Control Unit
H0264933	Custom Operators Seat Control Option

Please contact SIGMA for more information including details on an overhaul scope and interval. Maintenance periods and scope are dependent on application and site conditions, and are to be used as a guide.







MPR25MX1 EVAPORATOR

ROOFTOP PACKAGED HVAC UNIT

MPR25MX1

25kW 415VAC with Heating (9kW)

	COOLING 25.0 kW 85,300 BTU		HEATING (OPTION) 9.0 kW 30,708 BTU
	POWER SUPPLY 415 VAC 3 phase - 50Hz		AIR FLOW 900 l/s 1,907 CFM

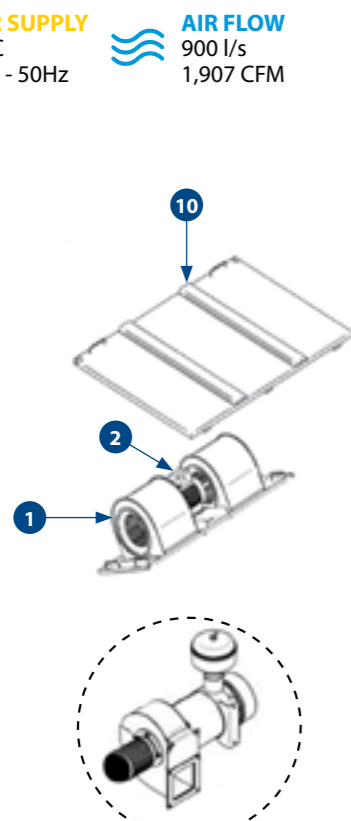

see **FVV100MR1** (pg 12) for pressuriser spare parts and maintenance

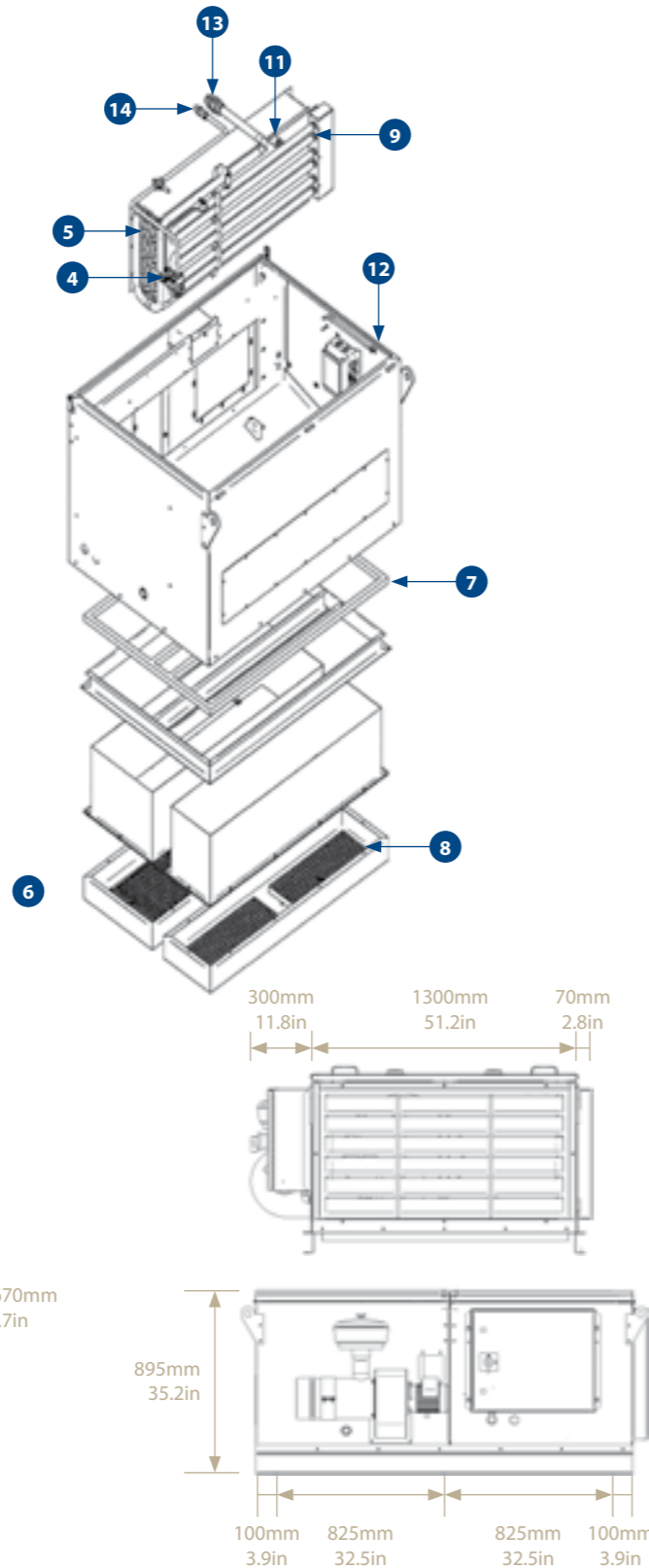

SPARE PARTS

PART NO.	DESCRIPTION	QTY
1	AU410130 BLOWER 250D X 242W X 19MM CW DI	2
2	UE321 MOTOR 1.1/0.37kW 90L 4/6P D/S	1
3	AU668134 COIL SOLENOID 24VAC AU522127 SOLENOID VALVE 200RB 5/8" SOLDER AU631451 PLUG PG9 SOL COIL 240VAC 10A	1 1 1
4	AU521512 TX VALVE 5T ANGLE 1/2" IN 5/8" OUT R134A AU521511 TX THERMOSTAT ELEM 5T R134A AU521515 TX ORIFICE 5T R134a #04	1 1 1
5	AU120161 EVAPORATOR COIL 990MM X 318MM X 137MM 6 RW M20A	1
6	A5503103S RETURN AIR FILTER 477MM X 312MM M15 (STANDARD)	2
7	H0235090 ROOF SEAL Previously AU08379	1
8	UC342 DIFFUSER 500MM X 200MM OPEN AREA DOUBLE DEFLECTION	2
9	UE272 HEATER U SHAPE 3KW 240V 975MM FIN	3
10	A5508307 EVAPORATOR LID	1
11	AU681020 HEATER OVER TEMPERATURE SWITCH	1
12	AU862211 SEAL RUBBER	5m
13	UR296 BULKHEAD 1 5/8" MJIC UR302 UNION 1 5/8" FJIC X 1 1/2 SL	1 1
14	UR011 BULKHEAD 5/8" MF	1

SPECIFICATIONS

	METRIC	IMPERIAL
Cooling Capacity	25.0 kW	85,300 BTU
Heating Capacity	9.0 kW	30,708 BTU
Fan Speeds	2	2
Air Flow	900 l/s	1,907 CFM
Fresh Air	100 l/s	212 CFM
Power Supply	415 VAC 3Phase-50Hz	415 VAC 3Phase-50Hz
Current Draw	33 A	33 A
Refrigerant	R134a	R134a
Maximum Ambient Temperature	54°C	129°F
Packaged Weight (nominal)	760.0 Kg	1672.0 lbs
Technical Manual Reference	SM277-2136	SM277-2136
Dimension (L X W X H)	1850 mm X 1670 mm X 895 mm	72.8 in X 65.7 in X 35.2 in

MAINTENANCE

ANNUAL / 5,400 HOURS

A5503103S	RETURN AIR FILTER 477MM x 312MM M15
-----------	-------------------------------------

3 YEARS / 16,200 HOURS

AU521511	TX THERMOSTAT ELEM 5T R134A
AU521515	TX ORIFICE 5T R134A #04
AU862211	SEAL RUBBER

COMPANION ITEMS

PART NO.	DESCRIPTION
AU460866	FILTER CARTRIDGE PLEAT 505MM X 330MM X 50MM (OPTIONAL)

Please contact SIGMA for more information including details on an overhaul scope and interval. Maintenance periods and scope are dependent on application and site conditions, and are to be used as a guide.



MPR25MX1





CONDENSER

ROOFTOP PACKAGED HVAC UNIT

MPR25MX1

25kW 415VAC with Heating (9kW)



	COOLING 25.0 kW 85,300 BTU		HEATING (OPTION) 9.0 kW 30,708 BTU
	POWER SUPPLY 415 VAC 3 phase - 50Hz		AIR FLOW 900 l/s 1,907 CFM

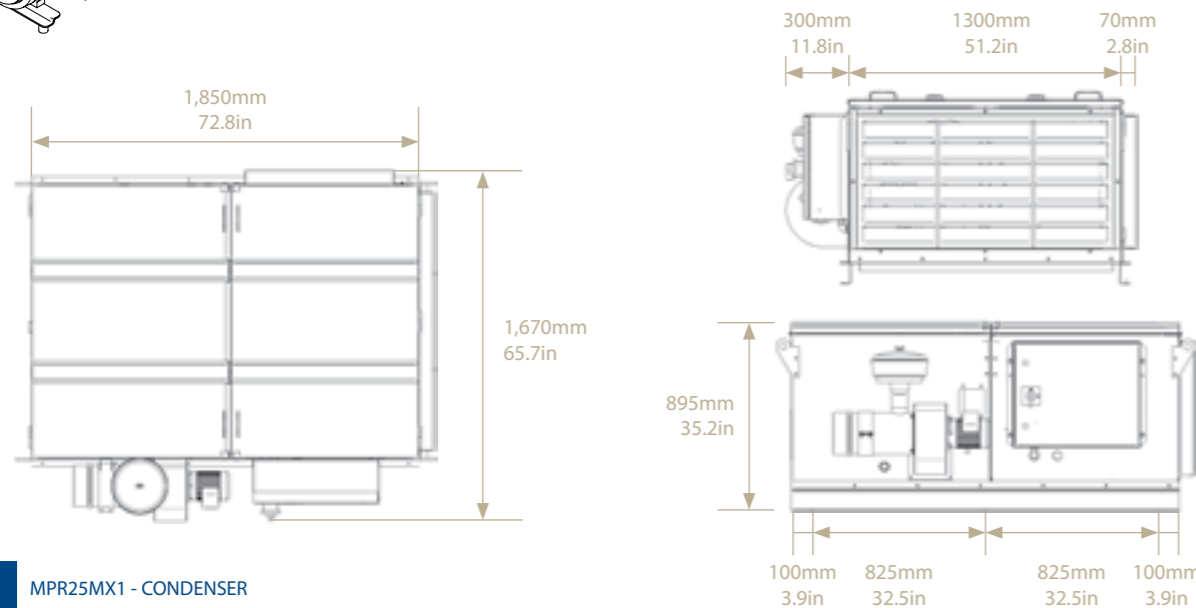
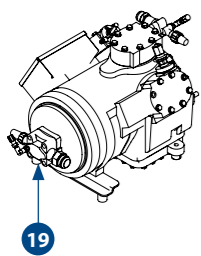
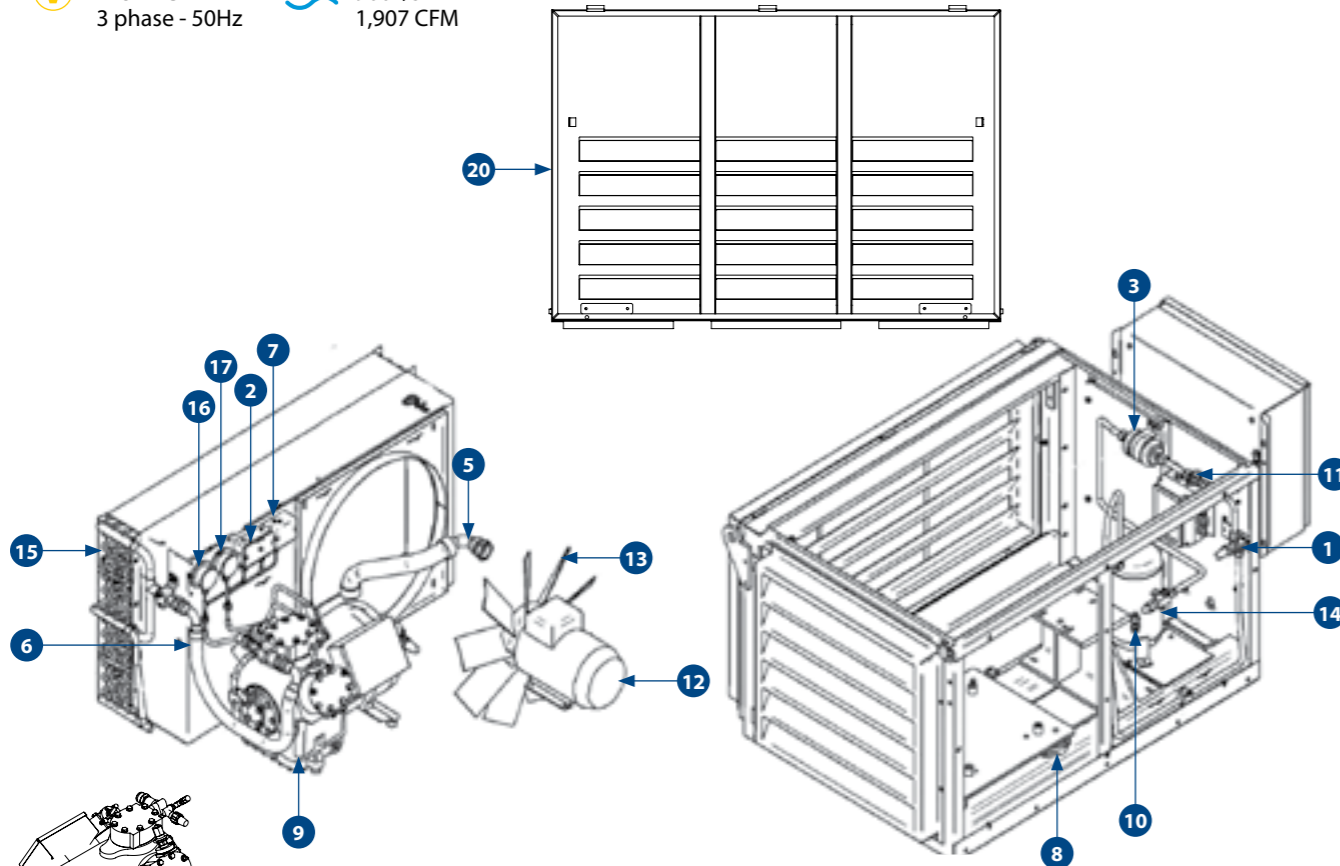

SPARE PARTS

PART NO.	DESCRIPTION	QTY
1	AU517208 PCLV 5/8" MF	1
2	AU523111 DUAL PRESSURE CONTROL LP AUTO HP MANUAL	1
3	AU531358 DRIER 5/8" MF	1
4	AS160182 HP FLEXIBLE HOSE ASSEMBLY	2
5	AS508426 SUCTION LINE HOSE	1
6	AS317814 HOSE DISCHARGE LINE	1
7	AU523606 HP CONTROL AUTO	1
8	AU845032 ANTI VIBRATION MOUNT	4
9	AU200014 COMPRESSOR WITH 2 ELECTRIC UNLOADER	1
10	AU527126 RELIEF VALVE 3/8"	1
11	AU533408 SIGHT GLASS	1
12	AU319037 MOTOR 1.85/0.55KW 100L 4/6P	1
13	AU420277 FAN AXIAL 560MM 9 BLADES	1
14	UR022 RECEIVER 330 X 168MM 5/8" SL X 5/8" ROTALOK	1
15	AU110162 CONDENSER COIL 1135MM X 635MM X 132MM 6RW M25	1
16	AU532331 GAUGE 63MM R134A 100 TO 1900 kPa	1
17	AU532330 GAUGE 63MM R134A 0 TO 2500kPa	1
18	AS3386352 VALVE DISCHARGE WITH FITTING	1
19	AS3386351 VALVE SUCTION WITH FITTING	1
20	AS231075 LID ASSEMBLY LOUVRE	1
21	AU200045 VALVE UNLOADER PRESSURE	1
22	AU200079 CRANKCASE HEATER 415V 75W	1
23	AU200061 VALVE UNLOADER ELECTRICAL	1
	AU517507 VALVE ACCESS 1/4"	1
	AU519074 ADAPTOR 134A 1/4" HIGH SIDE RED	1
	AU519075 ADAPTOR 134A 1/4" LOW SIDE BLUE	1
	AU542026 REFRIGERANT OIL	4

SPECIFICATIONS

	METRIC	IMPERIAL
Cooling Capacity	25.0 kW	85,300 BTU
Heating Capacity	9.0 kW	30,708 BTU
Fan Speeds	2	2
Air Flow	900 l/s	1,907 CFM
Fresh Air	100 l/s	212 CFM
Power Supply	415 VAC 3Phase-50Hz	415 VAC 3Phase-50Hz
Current Draw	33 A	33 A
Refrigerant	R134a	R134a
Maximum Ambient Temperature	54°C	129°F
Packaged Weight (nominal)	760.0 Kg	1672.0 lbs
Technical Manual Reference	SM277-2136	SM277-2136
Dimension (L X W X H)	1850 mm X 1670 mm X 895 mm	72.8 in X 65.7 in X 35.2 in

MAINTENANCE

ANNUAL / 5,400 HOURS

AU531358	DRIER 5/8" MF
----------	---------------

3 YEARS / 16,200 HOURS

AU523111	DUAL PRESSURE CONTROL LP AUTO HP MANUAL
AS160182	HP FLEXIBLE HOSE ASSEMBLY
AS508426	SUCTION LINE HOSE
AS508432	HOSE DISCHARGE LINE
AU523606	HP CONTROL AUTO
AU845032	ANTI VIBRATION MOUNT
AS3386352	VALVE DISCHARGE WITH FITTING
AS3386351	VALVE SUCTION WITH FITTING
AU542026	REFRIGERANT OIL

Please contact SIGMA for more information including details on an overhaul scope and interval. Maintenance periods and scope are dependent on application and site conditions, and are to be used as a guide.



MPR25MX1





ELECTRICAL

ROOFTOP PACKAGED HVAC UNIT

MPR25MX1

25kW 415VAC with Heating (9kW)



	COOLING 25.0 kW 85,300 BTU		HEATING (OPTION) 9.0 kW 30,708 BTU
	POWER SUPPLY 415 VAC 3 phase - 50Hz		AIR FLOW 900 l/s 1,907 CFM

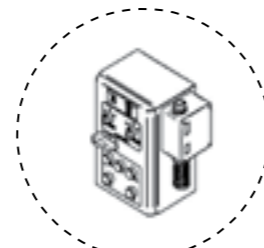
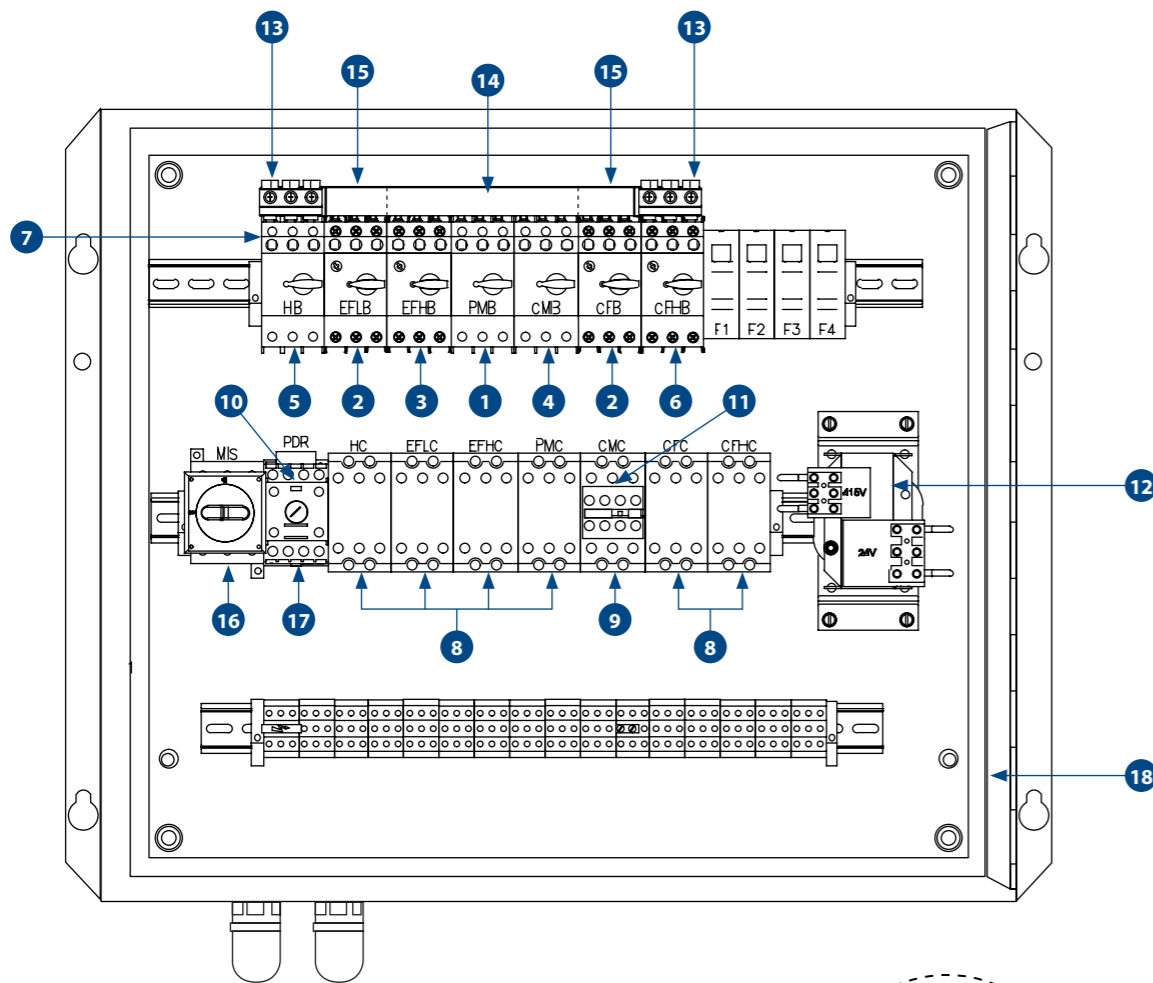

see **MEW1** (pg 100) for pilot control box spare parts

SPARE PARTS

PART NO.	DESCRIPTION	QTY
1	AU641486 CIRCUIT BREAKER 1.1-1.6A 3 POLE	1
2	AU641488 CIRCUIT BREAKER 1.8-2.5A 3 POLE	2
3	AU641490 CIRCUIT BREAKER 2.8-4.0A 3 POLE	1
4	AU641499 CIRCUIT BREAKER 20.0-25.0A 3 POLE	1
5	AU641496 CIRCUIT BREAKER 11.0-16.0A 3 POLE	1
6	AU641492 CIRCUIT BREAKER 4.5-6.3A 3 POLE	1
7	AU641501 CIRCUIT BREAKER AUX 1CO	7
8	AU651151 CONTACTOR 17A 24VAC 3 POLE 1NO 1NC	6
9	AU651178 CONTACTOR 25A 24VAC	1
10	AU653505 TIMER (3-30 SECONDS)	6
11	AU653602 AUXILIARY CONTACT 2NO 2NC	1
12	AU666089 TRANSFORMER 415V 24V 140VA 115W	1
13	642E10063 BUSBAR TERMINAL	2
14	AU635609 BUSBAR 5 BREAKER 3RV	1
15	AU635610 BUSBAR 2 BREAKER 3RV	2
16	AU642070 SWITCH ISOLATION ROTARY 80A	1
17	AU651056 CONTACTOR 12A 3 POLE 24VAC 1NC	1
18	AU862211 SEAL RUBBER	2.5m
	AU851556 LATCH 1/4 TURN DOUBLE WING 5MM PIN	2
	AU851588 KEY DOUBLE WING 5MM PIN SUIT AU851556	1

SPECIFICATIONS

	METRIC	IMPERIAL
Cooling Capacity	25.0 kW	85,300 BTU
Heating Capacity	9.0 kW	30,708 BTU
Fan Speeds	2	2
Air Flow	900 l/s	1,907 CFM
Fresh Air	100 l/s	212 CFM
Power Supply	415 VAC 3Phase-50Hz	415 VAC 3Phase-50Hz
Current Draw	33 A	33 A
Refrigerant	R134a	R134a
Maximum Ambient Temperature	54°C	129°F
Packaged Weight (nominal)	760.0 Kg	1672.0 lbs
Technical Manual Reference	SM277-2136	SM277-2136
Dimension (L X W X H)	1850 mm X 1670 mm X 895 mm	72.8 in X 65.7 in X 35.2 in

MAINTENANCE

3 YEARS / 16,200 HOURS

AU653505	TIMER (3-30 SECONDS)
AU651056	CONTACTOR 12A 3 POLE 24VAC 1NC

Please contact SIGMA for more information including details on an overhaul scope and interval. Maintenance periods and scope are dependent on application and site conditions, and are to be used as a guide.



MPV5MX2

ROOFTOP PACKAGED HVAC UNIT

MPV5MX2

5kW 415VAC with Heating (3kW) without pressuriser



MPV5MX2 in wall mounted configuration fitted with MKWP1 (case sold separately)

- COOLING**
5.0 kW
17,060 BTU
- HEATING (OPTION)**
3.0 kW
10,236 BTU
- POWER SUPPLY**
415 VAC
3 phase - 50Hz
- AIR FLOW**
190 l/s
403 CFM

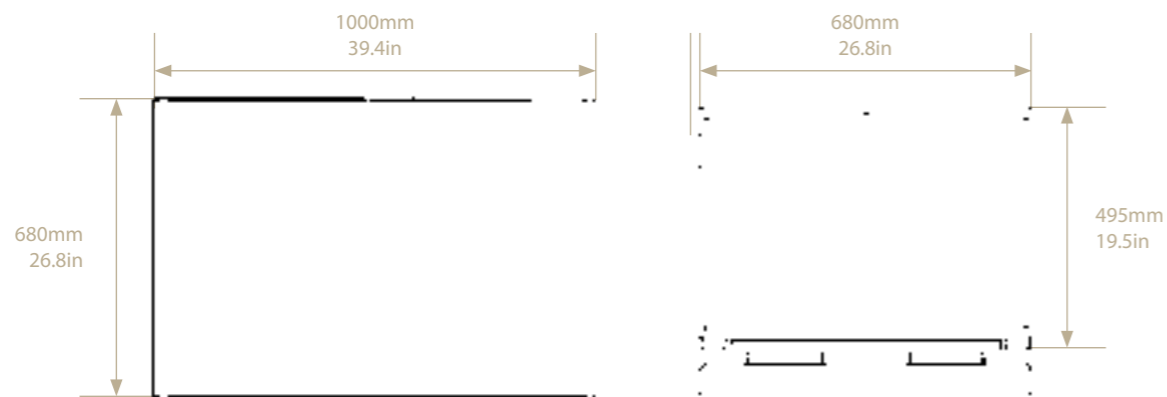
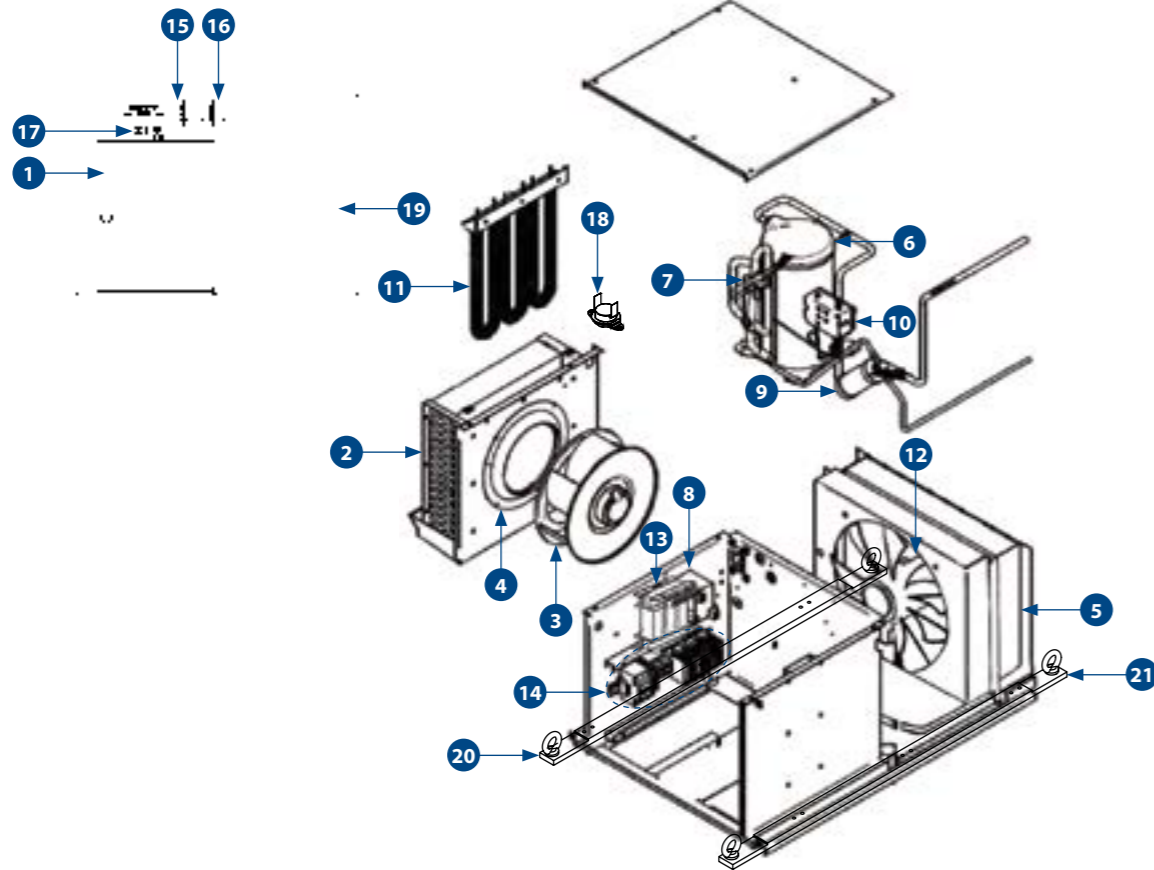

SPARE PARTS

PART NO.	DESCRIPTION	QTY
1	AU4601005 FILTER	1
2	AU120492 EVAPORATOR COIL 380MM X 381MM X 88MM 4 RW MPV5	1
3	H0661695 CENTRIFUGAL FAN 317D x 160W 415V 50Hz Previously AU411041	1
4	AU410953 INLET RING Ø188 ID X Ø280 OD Previously AU410956	1
5	AU110397 CONDENSER COIL 540X381X79 5RW MPV5	1
6	AU230806 COMPRESSOR 400VAC 50HZ 460VAC 60HZ	1
7	AU521509 TX VALVE 2T 3/8"IN 1/2"OUT 1/4EQ R134A	1
8	UE104 TRANSFORMER 415V/110VAC 115W SCREEN	1
9	AU531415 RECEIVER DRIER 3/8" MF 193MM HIGH	1
10	AU523112 DUAL PRESSURE CONTROL LP AUTO HP AUTO	1
11	AU691104 HEATER U SHAPE 1.0KW 240V 365MM BRS FIN	3
12	AU4201004 FAN AXIAL 400MM 400VAC	1
13	AU421020 FAN GRILLE SUIT 400MM	1
14	AU666090 TRANSFORMER 415-240V	1
15	AU651032 CONTACTOR 9A 3 POLE 110VAC	2
16	AU6511002 CONTACTOR 9A 110V	3
17	AU6511001 AUX CONTACT	3
18	AU641093 CIRCUIT BREAKER 16A 3 POLE	1
19	AU641096 CIRCUIT BREAKER 2A 1 POLE	1
20	AU6531003 MECHANICAL INTERLOCK	1
21	AU6631001 ROTARY SWITCH MODE	1
22	AU663004 ROTARY SWITCH FAN	1
23	AU681960 THERMOSTAT DIGITAL 24V	1
24	AU681961 SENSOR PROPE	1
25	AU681020 THERMOSTAT T5 50°C SPST N/C AUTO	1
26	AU821300 DIFFUSER ROUND	6
27	AU521509 TX VALVE 2T 3/8"IN 1/2" OUT 1/4" EQ R134A	1
28	AU521504 TX ORIFICE 2T R22 #04	1
29	AU523112 DUAL PRESSURE CONTROL LP AUTO HP AUTO	1
30	UE016 THERMOSTAT DEICE STUD	1
31	AU845248 ANTI VIBRATION MOUNT	4

CASE OPTIONS (SOLD SEPARATELY)

MKRP3	Outer Case Roof MTD	1
MKWP1	Outer Case Wall MTD	1

SPECIFICATIONS

	METRIC	IMPERIAL
Cooling Capacity	5.0 kW	17,060 BTU
Heating Capacity	3.0 kW	10,236 BTU
Fan Speeds	3	3
Air Flow	190 l/s	403 CFM
Fresh Air (Optional)	50 l/s	106 CFM
Power Supply	415 VAC 3Phase-50Hz	415 VAC 3Phase-50Hz
Current Draw	10 A	10 A
Refrigerant	R134a	R134a
Maximum Ambient Temperature	54°C	129°F
Packaged Weight (nominal)	150.0 Kg	330.0 lbs
Technical Manual Reference	SM347-5341	SM347-5341
Dimension (L X W X H)	1000 mm X 680 mm X 895 mm	39.4 in X 26.8 in X 19.5 in

MAINTENANCE

MONTHLY / 450 HOURS

AU4601005	FILTER
-----------	--------

ANNUAL / 5,400 HOURS

AU531415	RECEIVER DRIER 3/8" MF 193MM HIGH
----------	-----------------------------------

3 YEARS / 16,200 HOURS

AU521509	TX VALVE 2T 3/8"IN 1/2" OUT 1/4" EQ R134A
AU521504	TX ORIFICE 2T R22 #04
AU523112	DUAL PRESSURE CONTROL LP AUTO HP AUTO
UE016	THERMOSTAT DEICE STUD
AU845248	ANTI VIBRATION MOUNT

COMPANION ITEMS

PART NO.	DESCRIPTION
FV50M1	Fresh Air Pressuriser 50 l/s 415VAC

Please contact SIGMA for more information including details on an overhaul scope and interval. Maintenance periods and scope are dependent on application and site conditions, and are to be used as a guide.



MPW5MX1

REFRIGERATION / GENERAL ASSEMBLY

WALL MOUNT HVAC PACKAGED UNIT

MPW5MX1

5kW 415VAC with Heating (3kW) with Pressuriser

COOLING
5.0 kW
17,060 BTU

HEATING
3.0 kW
10,236 BTU

POWER SUPPLY
415 VAC
3 phase - 50Hz

AIR FLOW
200 l/s
424 CFM

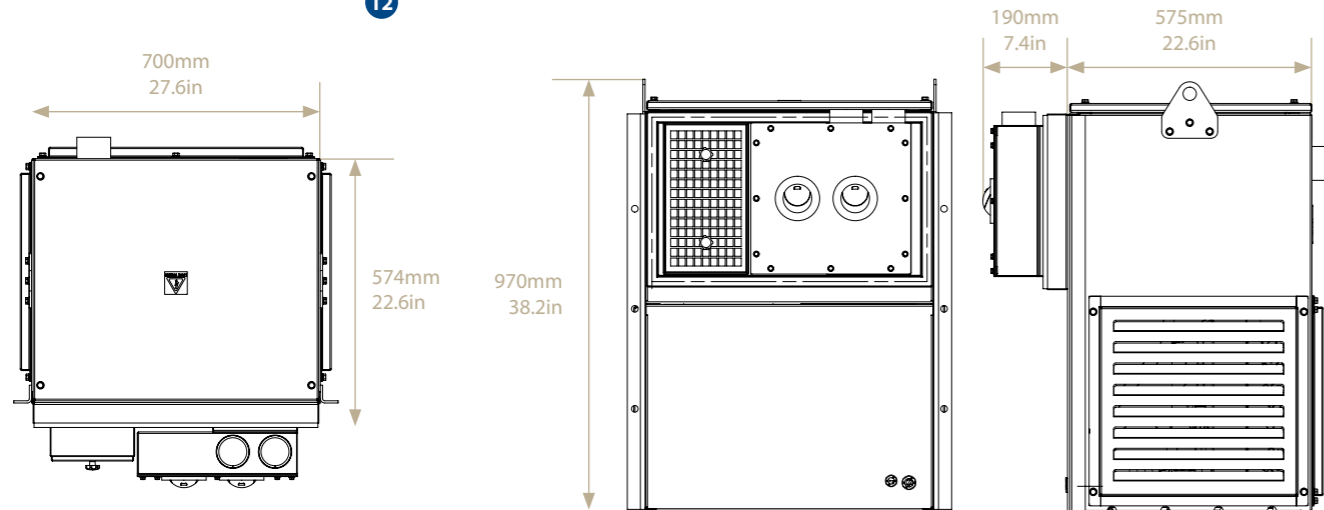
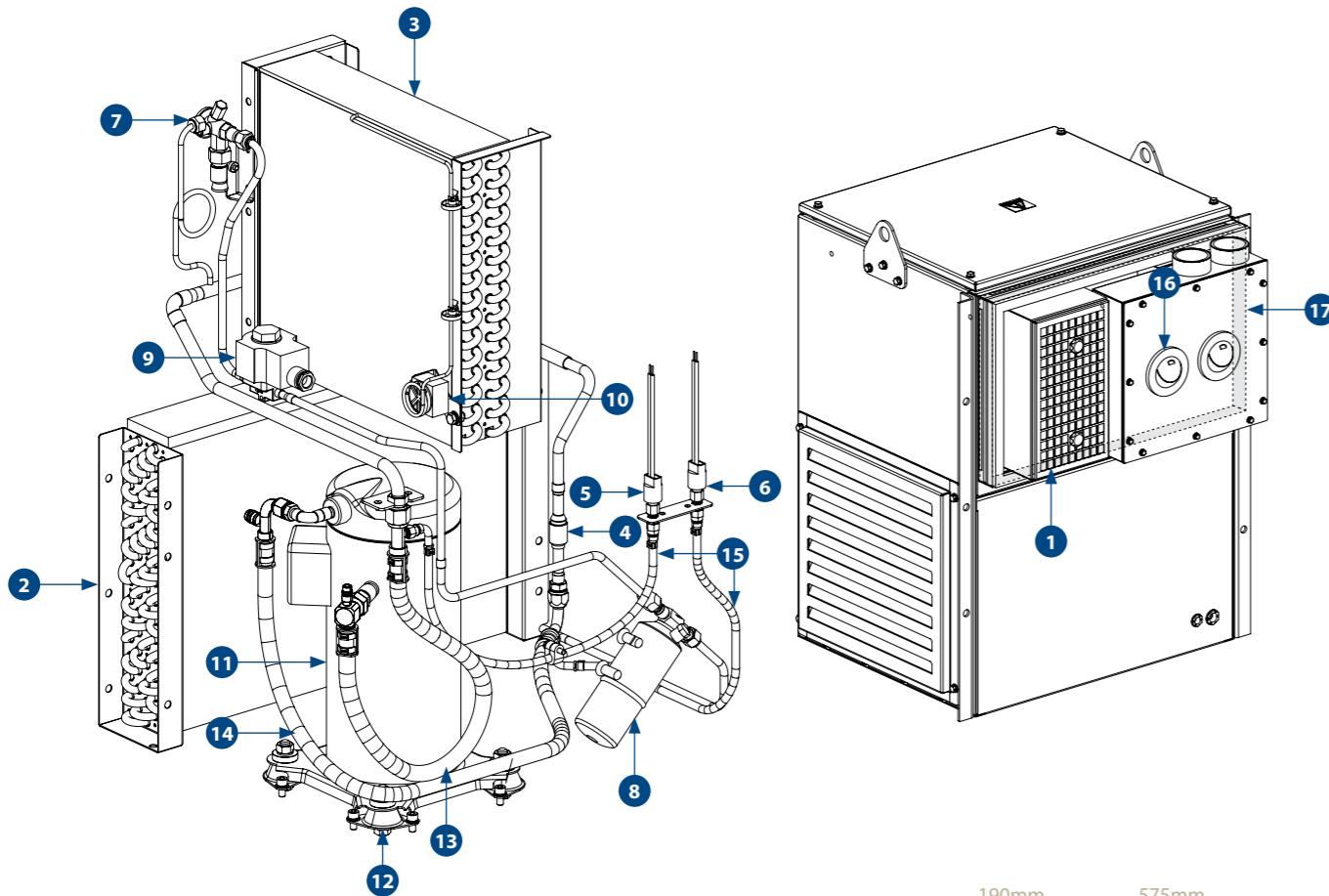

SPARE PARTS

PART NO.	DESCRIPTION	QTY
1	H0028308 FILTER MEDIA	1
2	AU110397 CONDENSER COIL 540MM X 381MM X 79MM 5RW MPV5	1
3	AU120492 EVAPORATOR COIL 380MM X 381MM X 88MM 4 RW MPV5	1
4	AU517621 VALVE CHECK 1/2SL STRAIGHT	1
5	AU523365 LOW PRESSURE SWITCH	1
6	AU523655 HIGH PRESSURE SWITCH	1
7	AU521509 TX VALVE 2T 3/8" IN 1/2" OUT 1/4" EQ R134A	1
8	AU521504 TX ORIFICE 2T R22 #04	1
9	AU531415 RECEIVER DRIER 3/8" MF 193MM HIGH	1
10	AU522021 SOLENOID VALVE	1
11	AU668140 COIL SOLENOID 24VDC TYPE 1	1
12	UE016 THERMOSTAT DEICE STUD	1
13	H0304197 COMPRESSOR ASSEMBLY	1
14	AU845248 ANTI VIBRATION MOUNT	4
15	H0227316 SUCTION HOSE ASSEMBLY	1
16	H0227314 DISCHARGE HOSE ASSEMBLY	1
17	HO227302 PRESSURE SWITCH HOSE ASSEMBLY	2
18	AU821301 DIFFUSER ROUND 75MM PLASTIC	2
19	H0032389 SEAL CABIN - SA & RA INTERFACE MPW5MX1	1
20	AU862211 SEAL RUBBER	1

SPECIFICATIONS

	METRIC	IMPERIAL
Cooling Capacity	5.0 kW	17,060 BTU
Heating Capacity	3.0 kW	10,236 BTU
Fan Speeds	3	3
Air Flow	200 l/s	424 CFM
Fresh Air (Optional)	30 l/s	64 CFM
Power Supply	415 VAC 3Phase-50Hz	415 VAC 3Phase-50Hz
Current Draw	10 A	10 A
Refrigerant	R134a	R134a
Maximum Ambient Temperature	54°C	129°F
Packaged Weight (nominal)	160.0 Kg	352.0 lbs
Technical Manual Reference	SM519-4077	SM519-4077
Dimension (L X W X H)	700 mm X 765 mm X 970 mm	27.6 in X 30.1 in X 38.2 in

MAINTENANCE

MONTHLY / 450 HOURS

H0028308	FILTER MEDIA
----------	--------------

ANNUAL / 5,400 HOURS

AU531415	RECEIVER DRIER 3/8" MF 193mm HIGH
----------	-----------------------------------

3 YEARS / 16,200 HOURS

AU521509	TX VALVE 2T 3/8" IN 1/2" OUT 1/4" EQ R134a
UE016	THERMOSTAT DEICE STUD
AU521504	TX ORIFICE 2T R22 #04
AU845248	ANTI VIBRATION MOUNT
H0227316	SUCTION HOSE ASSEMBLY
H0227314	DISCHARGE HOSE ASSEMBLY
HO227302	PRESSURE SWITCH HOSE ASSEMBLY

COMPANION ITEMS

PART NO.	DESCRIPTION
KNHV90029	Installation Kits
PVV50M2	Pressuriser
FVV40	Pressuriser
AU679519	Controller
AU6811015	Temperature Sensor



MPW5MX1





ELECTRICAL

WALL MOUNT HVAC PACKAGED UNIT

MPW5MX1

5kW 415VAC with Heating (3kW) with Pressuriser



	COOLING 5.0 kW 17,060 BTU		HEATING 3.0 kW 10,236 BTU
	POWER SUPPLY 415 VAC 3 phase - 50Hz		AIR FLOW 200 l/s 424 CFM

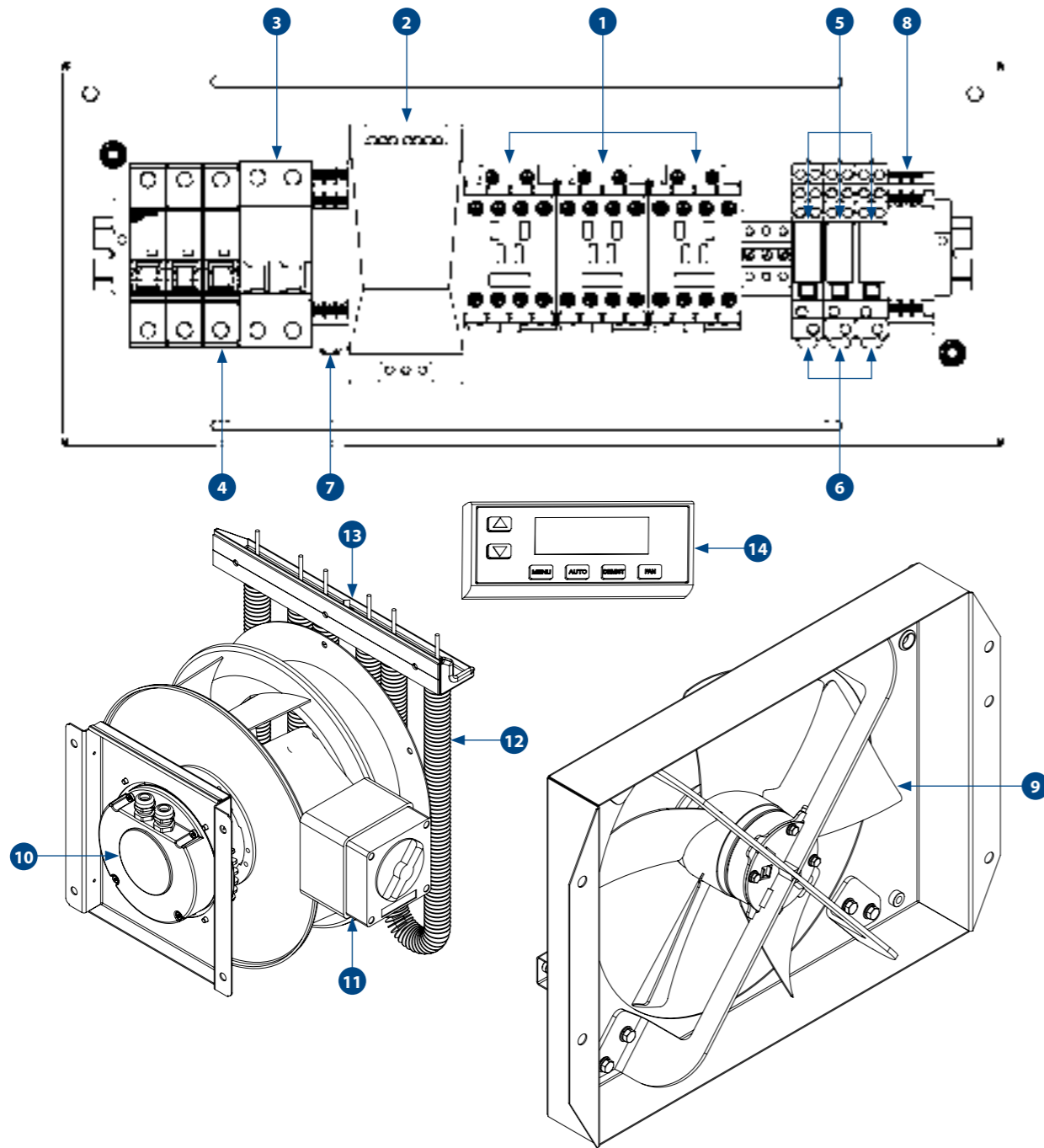

SPARE PARTS

PART NO.	DESCRIPTION	QTY
1	AU651047 CONTACTOR 12A 3 POLE 24VDC 1NO	3
2	AU677142 CONVERTER AC/DC IN 24VDC OUT 3A	1
3	AU641390 CIRCUIT BREAKER 4A 2 POLE	1
4	AU641093 CIRCUIT BREAKER 16A 3 POLE	1
5	AU661040 RELAY 8 PIN 24VDC 2 POLES	3
6	H0343830 RELAY BASE 8 PIN Previously AU661041	3
7	AU661043 RELAY POWER FAILURE 3 PHASE	1
8	AU672500 TIMER	1
9	AU4201004 FAN AXIAL 400MM	1
10	H0023291 BLOWER IMPELLER 307D x 222W 240VAC	1
11	H0023701 SWITCH 56SW420-GYCLIPSAL 4P 20A	1
12	AU691104 HEATER U SHAPE 1.0KW 240V 365mm BRS FIN	3
13	AU681020 THERMOSTAT T5 50°C SPST N/C AUTO	1
14	AU679519 CONTROLLER ELECTRICAL 24VDC DISPLAY	1
	AU6811015 THERMOSTAT SENSOR NTC -50 TO 105°C	1

SPECIFICATIONS

	METRIC	IMPERIAL
Cooling Capacity	5.0 kW	17,060 BTU
Heating Capacity	3.0 kW	10,236 BTU
Fan Speeds	3	3
Air Flow	200 l/s	424 CFM
Fresh Air (Optional)	30 l/s	64 CFM
Power Supply	415 VAC 3Phase-50Hz	415 VAC 3Phase-50Hz
Current Draw	10 A	10 A
Refrigerant	R134a	R134a
Maximum Ambient Temperature	54°C	129°F
Packaged Weight (nominal)	160.0 Kg	352.0 lbs
Technical Manual Reference	SM519-4077	SM519-4077
Dimension (L X W X H)	700 mm X 765 mm X 970 mm	27.6 in X 30.1 in X 38.2 in

COMPANION ITEMS

PART NO.	DESCRIPTION
KNHV90029	Installation Kits

Please contact SIGMA for more information including details on an overhaul scope and interval. Maintenance periods and scope are dependent on application and site conditions, and are to be used as a guide.